

aiwa



AV-D35

STEREO AV RECEIVER

• TYPE: EZ(B)

SIMPLE MANUAL

• Replace this Service Manual with "Revision Publishing" when it is issued.

S/M Code No. 09-993-326-8T2

MANUAL
SERVICE

ELECTRICAL MAIN PARTS LIST - 1

NOTE: The characters in the suffix column indicate the part usage.

REF.NO	PARTS NO.	NO.	DESCRIPTION	SUFFIX
EZ	XX	B
C	109	88-NF6-205-010	GUIDE, FL 40-150- 9	ABC
C	107	87-010-322-080	C-CAP, S 100P-50 CH	ABC
C	108	87-016-526-080	C-CAP, S 0.47-16 BK	ABC
C	105	87-016-526-080	C-CAP, S 0.47-16 BK	ABC
C	114	87-010-322-080	C-CAP, S 100P-50 CH	ABC
C	113	87-010-322-080	C-CAP, S 100P-50 CH	ABC
C	115	87-010-322-080	C-CAP, S 100P-50 CH	ABC
C	110	87-010-322-080	C-CAP, S 100P-50 CH	ABC
C	112	87-010-322-080	C-CAP, S 100P-50 CH	ABC
C	118	87-010-498-040	CAP, E 10-16 GAS	ABC
C	111	87-015-699-040	CAP, E 10-50 7L	ABC
C	116	87-015-699-040	CAP, E 10-50 7L	ABC
C	117	87-016-526-080	C-CAP, S 0.47-16 BK	ABC
C	123	87-010-196-080	CHIP CAPACITOR, 0.1-25	ABC
C	125	87-010-196-080	CHIP CAPACITOR, 0.1-25	ABC
C	129	87-010-196-080	CHIP CAPACITOR, 0.1-25	ABC
C	120	87-015-694-040	E/CAP 0.47-50	ABC
C	128	87-015-695-040	E/CAP 1UF 50V TAPG	ABC
C	124	87-015-699-040	CAP, E 10-50 7L	ABC
C	122	87-015-699-040	CAP, E 10-50 7L	ABC
C	121	87-016-526-080	C-CAP, S 0.47-16 BK	ABC
C	127	87-016-526-080	C-CAP, S 0.47-16 BK	ABC
C	126	87-A10-189-040	CAP, E 220-10	ABC
C	134	87-010-196-080	CHIP CAPACITOR, 0.1-25	ABC
C	130	87-010-198-080	CAP, CHIP 0.022	ABC
C	137	87-010-312-080	C-CAP, S 15P-50 CH	ABC
C	139	87-010-316-080	C-CAP, S 33P-50 CH	ABC
C	138	87-010-318-080	C-CAP, S 47P-50 CH	ABC
C	131	87-010-408-040	CAP, E 47-50 SME	ABC
C	132	87-012-368-080	C-CAP, S 0.1-50 F	ABC
C	133	87-016-526-080	C-CAP, S 0.47-16 BK	ABC
C	136	87-016-526-080	C-CAP, S 0.47-16 BK	ABC
C	140	87-010-196-080	CHIP CAPACITOR, 0.1-25	ABC
C	142	87-010-198-080	CAP, CHIP 0.022	ABC
C	141	87-012-156-080	C-CAP, S 220P-50 CH	ABC
C	143	87-012-156-080	C-CAP, S 220P-50 CH	ABC
C	153	87-012-368-080	C-CAP, S 0.1-50 F	ABC
C	154	87-012-368-080	C-CAP, S 0.1-50 F	ABC
C	158	87-012-368-080	C-CAP, S 0.1-50 F	ABC
C	156	87-015-699-040	CAP, E 10-50 7L	ABC
C	162	87-010-182-080	C-CAP, S 2200P-50 B	ABC
C	164	87-A10-189-040	CAP, E 220-10	ABC
C	171	87-012-157-080	C-CAP, S 330P-50 CH	ABC
C	188	87-010-178-080	CHIP CAP 1000P	ABC
C	189	87-010-178-080	CHIP CAP 1000P	ABC
C	190	87-010-178-080	CHIP CAP 1000P	ABC
C	240	87-016-526-080	C-CAP, S 0.47-16 BK	ABC
C	407	87-010-178-080	CHIP CAP 1000P	ABC
C	406	87-010-182-080	C-CAP, S 2200P-50 B	ABC
C	405	87-010-182-080	C-CAP, S 2200P-50 B	ABC
C	402	87-012-156-080	C-CAP, S 220P-50 CH	ABC
C	411	87-010-322-080	C-CAP, S 100P-50 CH	ABC
C	412	87-010-322-080	C-CAP, S 100P-50 CH	ABC
CN	202	87-A60-039-010	CONN, 32P V 9604S-32C	A.C
CN	201	87-A60-053-010	CONN, 17P V 9604S-17C	ABC
CN	203	87-A60-061-010	CONN, 06P V 9604S-06C	.C
CN	202	87-A60-553-010	CONN, 35P V 9604S-35C	.B
CN	401	87-009-371-010	CONNECTOR, 6P	.C
D	103	87-020-465-080	DIODE, 1SS133 (110MA)	ABC
D	102	87-020-465-080	DIODE, 1SS133 (110MA)	ABC
D	105	87-020-465-080	DIODE, 1SS133 (110MA)	ABC
D	104	87-020-465-080	DIODE, 1SS133 (110MA)	ABC
D	107	87-020-465-080	DIODE, 1SS133 (110MA)	ABC
D	106	87-020-465-080	DIODE, 1SS133 (110MA)	ABC
D	108	87-020-465-080	DIODE, 1SS133 (110MA)	ABC
D	101	87-A40-344-080	ZENER, MTZJ6.2C	ABC
D	122	87-020-465-080	DIODE, 1SS133 (110MA)	ABC
D	121	87-020-465-080	DIODE, 1SS133 (110MA)	ABC
FL	101	8Z-AR1-602-010	FL, BJ691 GK	ABC
IC	101	87-017-915-080	IC, BU4094BCF	ABC
IC	102	87-017-915-080	IC, BU4094BCF	ABC
IC	104	87-070-083-010	IC, GP1U281X	ABC
IC	103	8Z-AR3-610-010	C-IC, UPD780228GF	ABC
IC	103	8Z-AR3-611-010	C-IC, UPD780228GF-***
LED	108	87-A40-317-080	LED, SLR-342VCT31 RED	ABC
LED	101	87-A40-317-080	LED, SLR-342VCT31 RED	ABC
LED	104	87-A40-317-080	LED, SLR-342VCT31 RED	ABC
LED	106	87-A40-317-080	LED, SLR-342VCT31 RED	ABC
LED	107	87-A40-496-040	LED, SLR-342MCT31 GRN	ABC
LED	103	87-A40-496-040	LED, SLR-342MCT31 GRN	ABC
LED	105	87-A40-496-040	LED, SLR-342MCT31 GRN	ABC
LED	109	87-A40-496-040	LED, SLR-342MCT31 GRN	ABC
LED	102	87-A40-496-040	LED, SLR-342MCT31 GRN	ABC
LED	114	87-A40-317-080	LED, SLR-342VCT31 RED	ABC
LED	110	87-A40-317-080	LED, SLR-342VCT31 RED	ABC

ELECTRICAL MAIN PARTS LIST - 2

LED	119	87-A40-317-080	LED,SLR-342VCT31	RED	ABC.....	
LED	116	87-A40-317-080	LED,SLR-342VCT31	RED	ABC.....	
LED	112	87-A40-317-080	LED,SLR-342VCT31	RED	ABC.....	
LED	117	87-A40-496-040	LED,SLR-342MCT31	GRN	ABC.....	
LED	115	87-A40-496-040	LED,SLR-342MCT31	GRN	ABC.....	
LED	113	87-A40-496-040	LED,SLR-342MCT31	GRN	ABC.....	
LED	111	87-A40-496-040	LED,SLR-342MCT31	GRN	ABC.....	
Q	106	87-A30-071-080	C-TR,RT1N	144C	ABC.....	
Q	103	87-A30-073-080	C-TR,RT1N	141C	ABC.....	
Q	101	87-A30-073-080	C-TR,RT1N	141C	ABC.....	
Q	104	87-A30-073-080	C-TR,RT1N	141C	ABC.....	
Q	108	87-A30-073-080	C-TR,RT1N	141C	ABC.....	
Q	102	87-A30-073-080	C-TR,RT1N	141C	ABC.....	
Q	105	89-112-965-080	TR,2SA1296	(0.75W)	ABC.....	
Q	116	87-026-263-080	C-TR,RN1410		ABC.....	
Q	119	87-A30-071-080	C-TR,RT1N	144C	ABC.....	
Q	117	87-A30-071-080	C-TR,RT1N	144C	ABC.....	
Q	112	87-A30-073-080	C-TR,RT1N	141C	ABC.....	
Q	110	87-A30-073-080	C-TR,RT1N	141C	ABC.....	
Q	115	87-A30-073-080	C-TR,RT1N	141C	ABC.....	
Q	114	87-A30-073-080	C-TR,RT1N	141C	ABC.....	
Q	113	87-A30-074-080	C-TR,RT1P	141C	ABC.....	
Q	111	87-A30-087-080	C-FET,2SK2158		ABC.....	
Q	120	87-A30-071-080	C-TR,RT1N	144C	ABC.....	
S	101	87-A90-095-080	SW,TACT	EVQ11G04M	ABC.....	
S	108	87-A90-095-080	SW,TACT	EVQ11G04M	ABC.....	
S	107	87-A90-095-080	SW,TACT	EVQ11G04M	ABC.....	
S	109	87-A90-095-080	SW,TACT	EVQ11G04M	ABC.....	
S	114	87-A90-095-080	SW,TACT	EVQ11G04M	ABC.....	
S	111	87-A90-095-080	SW,TACT	EVQ11G04M	ABC.....	
S	115	87-A90-095-080	SW,TACT	EVQ11G04M	ABC.....	
S	112	87-A90-095-080	SW,TACT	EVQ11G04M	ABC.....	
S	113	87-A90-095-080	SW,TACT	EVQ11G04M	ABC.....	
S	116	87-A90-095-080	SW,TACT	EVQ11G04M	ABC.....	
SW	101	87-A90-535-010	SW,RTRY	EC16B24304	ABC.....	
SW	102	87-A90-950-010	SW,RTRY	EC12E12504	ENCORDER	ABC.....
X	101	87-A70-075-080	VIB,CER	4.19MHZ CRHF	ABC.....	
C	503	87-012-157-080	C-CAP,S	330P-50 CH	ABC.....	
C	504	87-012-157-080	C-CAP,S	330P-50 CH	ABC.....	
C	519	87-010-196-080	CHIP CAPACITOR,	0.1-25	ABC.....	
C	517	87-010-196-080	CHIP CAPACITOR,	0.1-25	ABC.....	
C	518	87-010-196-080	CHIP CAPACITOR,	0.1-25	ABC.....	
C	513	87-010-260-080	CAP, ELECT	47-25V	ABC.....	
C	514	87-010-260-080	CAP, ELECT	47-25V	ABC.....	
C	515	87-010-370-080	CAP,E	330-6.3 SME	ABC.....	
C	516	87-010-370-080	CAP,E	330-6.3 SME	ABC.....	
C	520	87-010-196-080	CHIP CAPACITOR,	0.1-25	ABC.....	
C	531	87-010-213-080	C-CAP,S	0.015-50 B	ABC.....	
C	539	87-010-401-080	CAP, ELECT	1-50V	ABC.....	
C	533	87-015-785-080	CHIP CAPACITOR,	0.1FZ-25Z	ABC.....	
C	541	87-010-185-080	C-CAP,S	3900P-50 B	ABC.....	
C	542	87-010-185-080	C-CAP,S	3900P-50 B	ABC.....	
C	540	87-010-401-080	CAP, ELECT	1-50V	ABC.....	
C	549	87-016-081-080	C-CAP,S	0.1-16 RK	ABC.....	
C	559	87-010-183-080	C-CAP,S	2700P-50 B	ABC.....	
C	554	87-010-196-080	CHIP CAPACITOR,	0.1-25	ABC.....	
C	556	87-010-248-080	CAP, ELECT	220-10V	ABC.....	
C	557	87-010-405-080	CAP, ELECT	10-50V	ABC.....	
C	555	87-010-405-080	CAP, ELECT	10-50V	ABC.....	
C	558	87-010-992-080	C-CAP,S	0.047-25 B	ABC.....	
C	550	87-016-081-080	C-CAP,S	0.1-16 RK	ABC.....	
C	566	87-010-404-080	CAP, ELECT	4.7-50V	ABC.....	
C	561	87-012-140-080	CAP	470P	ABC.....	
C	562	87-012-140-080	CAP	470P	ABC.....	
CN	501	87-A60-039-010	CONN,32P	V 9604S-32C	A.C	
CN	503	87-A60-057-010	CONN,11P	V 9604S-11C	ABC.....	
CN	502	87-A60-061-010	CONN,06P	V 9604S-06C	.C	
CN	506	87-A60-063-010	CONN,04P	V 9604S-04C	.B	
CN	501	87-A60-553-010	CONN,35P	V 9604S-35C	.B	
CN	702	87-099-568-010	CONN,11P	TUC-P11P-B1	ABC.....	
D	503	87-070-274-080	DIODE,1N4003	SEM	ABC.....	
D	502	87-A40-438-080	ZENER,MTZJ4.7A		ABC.....	
D	501	87-A40-438-080	ZENER,MTZJ4.7A		ABC.....	
IC	501	87-017-022-080	IC,NJM2068M-D(T1)		ABC.....	
IC	502	87-017-726-080	IC,BU4052	BCF	ABC.....	
IC	503	87-A21-202-040	C-IC,M62445AFP		ABC.....	
J	501	87-099-609-010	JACK,PIN	4P KM EARTH	ABC.....	
J	502	87-099-609-010	JACK,PIN	4P KM EARTH	ABC.....	
		87-067-579-010	TAPPING SCREW,	BVT2+3-8	ABC.....	
C	102	87-010-235-080	CAP,E	470-16 SME	ABC.....	
C	101	87-010-235-080	CAP,E	470-16 SME	ABC.....	
C	104	87-010-382-080	CAP, ELECT	22-25V	ABC.....	
C	106	87-010-384-080	CAP, ELECT	100-25V	ABC.....	
C	103	87-010-384-080	CAP, ELECT	100-25V	ABC.....	
C	108	87-012-140-080	CAP	470P	ABC.....	
C	109	87-012-368-080	C-CAP,S	0.1-50 F	ABC.....	
C	115	87-012-368-080	C-CAP,S	0.1-50 F	ABC.....	
C	118	87-012-368-080	C-CAP,S	0.1-50 F	ABC.....	
C	116	87-012-368-080	C-CAP,S	0.1-50 F	ABC.....	
C	111	87-012-368-080	C-CAP,S	0.1-50 F	ABC.....	
C	110	87-012-368-080	C-CAP,S	0.1-50 F	ABC.....	
C	112	87-012-368-080	C-CAP,S	0.1-50 F	ABC.....	
C	117	87-012-368-080	C-CAP,S	0.1-50 F	ABC.....	

ELECTRICAL MAIN PARTS LIST - 3

C	114	87-016-658-090	CAP,E 4700-35 SMG	ABC.....
C	113	87-016-658-090	CAP,E 4700-35 SMG	ABC.....
C	119	87-A10-462-090	CAP,E 6800-63 SMG VB	ABC.....
C	127	87-010-197-080	CAP, CHIP 0.01 DM	ABC.....
C	125	87-010-247-080	CAP, ELECT 100-50V	ABC.....
C	121	87-010-260-080	CAP, ELECT 47-25V	ABC.....
C	126	87-010-263-080	CAP, ELECT 100-10V	ABC.....
C	123	87-010-385-080	CAP, ELECT 220-25V	ABC.....
C	122	87-010-403-080	CAP, ELECT 3.3-50V	ABC.....
C	120	87-A10-462-090	CAP,E 6800-63 SMG VB	ABC.....
C	143	87-A10-712-080	C-CAP,S 0.22-50 Z F	..C.....
C	144	87-A10-712-080	C-CAP,S 0.22-50 Z F	..C.....
CN	110	87-009-032-010	CONNECTOR,4P YEL	ABC.....
D	107	87-A40-115-060	DIODE,RS603M	ABC.....
D	101	87-A40-345-080	ZENER,MTZJ10C	ABC.....
D	102	87-A40-468-080	C-DIODE,HSM2836CTR	ABC.....
D	108	87-A40-468-080	C-DIODE,HSM2836CTR	ABC.....
D	109	87-A40-469-080	C-DIODE,HSM2838CTR	ABC.....
D	110	87-A40-004-080	ZENER,MTZJ16A	ABC.....
D	112	87-A40-335-080	ZENER,MTZJ11C T-72	ABC.....
D	126	87-020-465-080	DIODE,1SS133 (110MA)	ABC.....
D	125	87-020-465-080	DIODE,1SS133 (110MA)	ABC.....
D	123	87-070-274-080	DIODE,1N4003 SEM	ABC.....
D	122	87-070-274-080	DIODE,1N4003 SEM	ABC.....
D	121	87-A40-224-010	DIODE,GBU8D	ABC.....
D	124	87-A40-435-080	ZENER,MTZJ30D	ABC.....
PR	101	87-026-682-080	PROTECTOR,10A 60V491	.BC.....
PR	104	87-026-682-080	PROTECTOR,10A 60V491	.BC.....
PR	101	87-026-691-080	FUSE,10A 125V 251	A.....
PR	104	87-026-691-080	FUSE,10A 125V 251	A.....
Q	107	87-026-610-080	TR,KTC3198GR	ABC.....
Q	106	87-A30-076-080	C-TR,2SC3052F	ABC.....
Q	103	87-A30-083-080	TR,CSD1489B	ABC.....
Q	104	87-A30-085-040	C-TR,CSA1362GR	..C.....
Q	101	89-110-372-080	TR,2SA1037(140MHZ 200MW)	ABC.....
Q	108	89-213-702-010	TR,2SB1370 (1.8W)	ABC.....
Q	109	89-213-702-010	TR,2SB1370 (1.8W)	ABC.....
Q	102	89-213-750-010	TR,2SB1375 (25W)	ABC.....
Q	118	87-026-609-080	TR,KTA1266GR	ABC.....
Q	117	87-026-609-080	TR,KTA1266GR	ABC.....
Q	115	87-A30-075-080	C-TR,2SA1235F	ABC.....
Q	113	87-A30-075-080	C-TR,2SA1235F	ABC.....
Q	116	87-A30-076-080	C-TR,2SC3052F	ABC.....
Q	112	87-A30-076-080	C-TR,2SC3052F	ABC.....
Q	114	87-A30-076-080	C-TR,2SC3052F	ABC.....
R	109	87-029-060-080	RES,FUSE 33-1/4 W	ABC.....
R	143	87-A00-261-080	RES,M/F 0.56-1W J	A.....
W	3	8Z-NF3-645-010	CONN ASSY,9P VH	ABC.....
WH	101	87-A90-510-010	HLD, WIRE 2.5-9P	ABC.....
		87-067-579-010	TAPPING SCREW, BVT2+3-8	..C.....
		87-067-703-010	TAPPING SCREW, BVT2+3-10	AB.....
C	203	87-010-176-080	C-CAP,S 680P-50 SL	ABC.....
C	204	87-010-176-080	C-CAP,S 680P-50 SL	ABC.....
C	209	87-010-392-080	CAP ELECT 33SME-35V	..C.....
C	206	87-010-405-080	CAP, ELECT 10-50V	ABC.....
C	205	87-010-405-080	CAP, ELECT 10-50V	ABC.....
C	208	87-016-299-080	CAP,E 10-100 SME	ABC.....
C	211	87-010-322-080	C-CAP,S 100P-50 CH	ABC.....
C	212	87-010-322-080	C-CAP,S 100P-50 CH	ABC.....
C	210	87-010-392-080	CAP ELECT 33SME-35V	..C.....
C	218	87-A10-516-080	C-CAP,S 100P-200 J CH	ABC.....
C	217	87-A10-516-080	C-CAP,S 100P-200 J CH	ABC.....
C	216	87-A10-897-080	CAP,E 100-25 BP SME	ABC.....
C	215	87-A10-897-080	CAP,E 100-25 BP SME	ABC.....
C	227	87-010-178-080	CHIP CAP 1000P	ABC.....
C	228	87-010-178-080	CHIP CAP 1000P	ABC.....
C	225	87-010-196-080	CHIP CAPACITOR,0.1-25	ABC.....
C	229	87-010-384-080	CAP, ELECT 100-25V	AB.....
C	226	87-010-384-080	CAP, ELECT 100-25V	AB.....
C	224	87-010-402-080	CAP, ELECT 2.2-50V	ABC.....
C	223	87-010-402-080	CAP, ELECT 2.2-50V	ABC.....
C	221	87-010-805-080	CAP, S 1-16	ABC.....
C	222	87-010-805-080	CAP, S 1-16	ABC.....
C	229	87-016-251-080	CAP,E 220-16 M SMG	..C.....
C	226	87-016-251-080	CAP,E 220-16 M SMG	..C.....
C	231	87-A10-354-080	C-CAP,S 0.047-50 K B	ABC.....
C	230	87-A10-354-080	C-CAP,S 0.047-50 K B	ABC.....
C	232	87-A10-946-080	C-CAP,S 220P-100 J CH	..C.....
C	285	87-010-186-080	CAP,CHIP 4700P	ABC.....
C	289	87-010-190-080	S CHIP F 0.01	A.C.....
C	287	87-010-190-080	S CHIP F 0.01	A.C.....
C	288	87-010-190-080	S CHIP F 0.01	A.C.....
C	287	87-010-191-080	C-CAP,S 0.015-50 F	.B.....
C	289	87-010-191-080	C-CAP,S 0.015-50 F	.B.....
C	288	87-010-191-080	C-CAP,S 0.015-50 F	.B.....
C	290	87-010-190-080	S CHIP F 0.01	A.C.....
C	290	87-010-191-080	C-CAP,S 0.015-50 F	.B.....
C	303	87-010-179-080	CAP,CHIP S B1200P	ABC.....
C	304	87-010-179-080	CAP,CHIP S B1200P	ABC.....
C	309	87-010-260-080	CAP, ELECT 47-25V	ABC.....
C	305	87-010-404-080	CAP, ELECT 4.7-50V	AB.....
C	306	87-010-404-080	CAP, ELECT 4.7-50V	AB.....
C	308	87-016-299-080	CAP,E 10-100 SME	ABC.....

ELECTRICAL MAIN PARTS LIST - 4

C	310	87-010-260-080	CAP, ELECT 47-25V	ABC.....
C	312	87-010-322-080	C-CAP,S 100P-50 CH	ABC.....
C	311	87-010-322-080	C-CAP,S 100P-50 CH	ABC.....
C	317	87-A10-516-080	C-CAP,S 100P-200 J CH	ABC.....
C	318	87-A10-516-080	C-CAP,S 100P-200 J CH	ABC.....
C	315	87-A10-897-080	CAP,E 100-25 BP SME	ABC.....
C	316	87-A10-897-080	CAP,E 100-25 BP SME	ABC.....
C	327	87-010-178-080	CHIP CAP 1000P	ABC.....
C	328	87-010-178-080	CHIP CAP 1000P	ABC.....
C	325	87-010-196-080	CHIP CAPACITOR,0.1-25	ABC.....
C	323	87-010-402-080	CAP, ELECT 2.2-50V	ABC.....
C	324	87-010-402-080	CAP, ELECT 2.2-50V	ABC.....
C	322	87-010-805-080	CAP, S 1-16	ABC.....
C	321	87-010-805-080	CAP, S 1-16	ABC.....
C	320	87-A10-946-080	C-CAP,S 220P-100 J CH	..C.....
C	330	87-A10-354-080	C-CAP,S 0.047-50 K B	ABC.....
C	331	87-A10-354-080	C-CAP,S 0.047-50 K B	ABC.....
C	335	87-A10-918-080	CAP,E 100-16 SMG	ABC.....
C	334	87-A10-918-080	CAP,E 100-16 SMG	ABC.....
C	385	87-010-186-080	CAP,CHIP 4700P	ABC.....
C	396	87-010-190-080	S CHIP F 0.01	A.C.....
C	395	87-010-190-080	S CHIP F 0.01	A.C.....
C	395	87-010-191-080	C-CAP,S 0.015-50 F	.B.....
C	396	87-010-191-080	C-CAP,S 0.015-50 F	.B.....
C	393	87-012-368-080	C-CAP,S 0.1-50 F	ABC.....
C	394	87-012-368-080	C-CAP,S 0.1-50 F	ABC.....
C	402	87-010-181-080	CAP,CHIP S 1800P	ABC.....
C	406	87-010-322-080	C-CAP,S 100P-50 CH	ABC.....
C	403	87-010-405-080	CAP, ELECT 10-50V	ABC.....
C	405	87-010-406-080	CAP, ELECT 22-50	ABC.....
C	409	87-A10-516-080	C-CAP,S 100P-200 J CH	ABC.....
C	408	87-A10-897-080	CAP,E 100-25 BP SME	ABC.....
C	414	87-010-178-080	CHIP CAP 1000P	ABC.....
C	413	87-010-196-080	CHIP CAPACITOR,0.1-25	ABC.....
C	412	87-010-402-080	CAP, ELECT 2.2-50V	ABC.....
C	411	87-010-805-080	CAP, S 1-16	ABC.....
C	416	87-016-299-080	CAP,E 10-100 SME	ABC.....
C	417	87-A10-946-080	C-CAP,S 220P-100 J CH	..C.....
C	420	87-A10-354-080	C-CAP,S 0.047-50 K B	ABC.....
C	485	87-010-186-080	CAP,CHIP 4700P	ABC.....
C	493	87-010-190-080	S CHIP F 0.01	A.C.....
C	493	87-010-191-080	C-CAP,S 0.015-50 F	.B.....
C	491	87-012-368-080	C-CAP,S 0.1-50 F	ABC.....
C	492	87-012-368-080	C-CAP,S 0.1-50 F	ABC.....
C	745	87-012-368-080	C-CAP,S 0.1-50 F	ABC.....
CNA	202	8Z-AR4-605-010	CONN ASSY,6P VH	..C.....
CNA	201	8Z-AR4-606-010	CONN ASSY,8P VH	..C.....
D	213	87-070-136-080	ZENER,MTZJ5.1B	ABC.....
D	211	87-A40-274-010	DIODE,FMB-G16L	A.....
D	212	87-A40-274-010	DIODE,FMB-G16L	A.....
D	214	87-A40-344-080	ZENER,MTZJ6.2C	ABC.....
D	211	87-A40-646-010	DIODE,FMB-G16L	.BC.....
D	212	87-A40-646-010	DIODE,FMB-G16L	.BC.....
D	221	87-070-274-080	DIODE,1N4003 SEM	ABC.....
D	243	87-A40-345-080	ZENER,MTZJ10C	ABC.....
D	242	87-A40-488-080	DIODE,1SS244	ABC.....
D	241	87-A40-488-080	DIODE,1SS244	ABC.....
D	313	87-070-136-080	ZENER,MTZJ5.1B	ABC.....
D	311	87-A40-274-010	DIODE,FMB-G16L	A.....
D	312	87-A40-274-010	DIODE,FMB-G16L	A.....
D	314	87-A40-344-080	ZENER,MTZJ6.2C	ABC.....
D	311	87-A40-646-010	DIODE,FMB-G16L	.BC.....
D	312	87-A40-646-010	DIODE,FMB-G16L	.BC.....
D	321	87-070-274-080	DIODE,1N4003 SEM	ABC.....
D	343	87-A40-345-080	ZENER,MTZJ10C	ABC.....
D	341	87-A40-488-080	DIODE,1SS244	ABC.....
D	342	87-A40-488-080	DIODE,1SS244	ABC.....
D	405	87-020-465-080	DIODE,1SS133 (110MA)	ABC.....
D	401	87-020-465-080	DIODE,1SS133 (110MA)	ABC.....
D	408	87-070-136-080	ZENER,MTZJ5.1B	ABC.....
D	407	87-A40-274-010	DIODE,FMB-G16L	A.....
D	406	87-A40-274-010	DIODE,FMB-G16L	A.....
D	409	87-A40-344-080	ZENER,MTZJ6.2C	ABC.....
D	406	87-A40-646-010	DIODE,FMB-G16L	.BC.....
D	407	87-A40-646-010	DIODE,FMB-G16L	.BC.....
D	410	87-020-465-080	DIODE,1SS133 (110MA)	ABC.....
D	414	87-020-465-080	DIODE,1SS133 (110MA)	ABC.....
D	412	87-020-465-080	DIODE,1SS133 (110MA)	ABC.....
D	411	87-020-465-080	DIODE,1SS133 (110MA)	ABC.....
D	413	87-070-274-080	DIODE,1N4003 SEM	ABC.....
D	425	87-020-465-080	DIODE,1SS133 (110MA)	ABC.....
D	423	87-020-465-080	DIODE,1SS133 (110MA)	ABC.....
D	420	87-020-465-080	DIODE,1SS133 (110MA)	ABC.....
D	433	87-A40-345-080	ZENER,MTZJ10C	ABC.....
D	441	87-020-465-080	DIODE,1SS133 (110MA)	ABC.....
J	201	87-A60-199-010	TERMINAL,SP 8P CJ-9034-07 V0	AB.....
J	301	87-A60-200-110	TERMINAL,SP 6P CJ-9033	AB.....
J	715	87-A60-244-010	JACK,PIN 1P BLK	ABC.....
L	294	87-003-383-010	COIL,1UH-S	ABC.....
L	291	87-003-383-010	COIL,1UH-S	ABC.....
L	293	87-003-383-010	COIL,1UH-S	ABC.....
L	292	87-003-383-010	COIL,1UH-S	ABC.....
L	392	87-003-383-010	COIL,1UH-S	ABC.....

ELECTRICAL MAIN PARTS LIST - 5

L	391	87-003-383-010	COIL, 1UH-S	ABC.....
L	491	87-003-383-010	COIL, 1UH-S	ABC.....
PR	202	87-026-682-080	PROTECTOR, 10A 60V491	.BC.....
PR	201	87-026-682-080	PROTECTOR, 10A 60V491	.BC.....
PR	201	87-026-691-080	FUSE, 10A 125V 251	A.....
PR	202	87-026-691-080	FUSE, 10A 125V 251	A.....
PR	302	87-026-682-080	PROTECTOR, 10A 60V491	.BC.....
PR	301	87-026-682-080	PROTECTOR, 10A 60V491	.BC.....
PR	301	87-026-691-080	FUSE, 10A 125V 251	A.....
PR	302	87-026-691-080	FUSE, 10A 125V 251	A.....
PR	401	87-026-682-080	PROTECTOR, 10A 60V491	.BC.....
PR	402	87-026-682-080	PROTECTOR, 10A 60V491	.BC.....
PR	401	87-026-691-080	FUSE, 10A 125V 251	A.....
PR	402	87-026-691-080	FUSE, 10A 125V 251	A.....
Q	201	87-A30-257-080	C-TR, 2SD1306E	ABC.....
Q	202	87-A30-257-080	C-TR, 2SD1306E	ABC.....
Q	213	87-A30-097-010	TR, FN 1016	ABC.....
Q	214	87-A30-097-010	TR, FN 1016	ABC.....
Q	215	87-A30-098-010	TR, FP 1016	ABC.....
Q	216	87-A30-098-010	TR, FP 1016	ABC.....
Q	218	87-A30-106-070	C-TR, CMBT5551	ABC.....
Q	217	87-A30-106-070	C-TR, CMBT5551	ABC.....
Q	219	87-A30-162-010	FET, 2SK2937	ABC.....
Q	211	87-A30-190-080	TR, CC5551	ABC.....
Q	212	87-A30-190-080	TR, CC5551	ABC.....
Q	228	87-026-232-080	TR, DTA144WK	ABC.....
Q	226	87-026-236-080	TR, DTC124E, K	ABC.....
Q	221	87-A30-072-080	C-TR, RT1P 144C	ABC.....
Q	223	87-A30-074-080	C-TR, RT1P 141C	.BC.....
Q	227	87-A30-075-080	C-TR, 2SA1235F	ABC.....
Q	225	87-A30-075-080	C-TR, 2SA1235F	ABC.....
Q	220	87-A30-162-010	FET, 2SK2937	ABC.....
Q	240	87-A30-107-070	C-TR, CMBT5401	ABC.....
Q	301	87-A30-257-080	C-TR, 2SD1306E	ABC.....
Q	302	87-A30-257-080	C-TR, 2SD1306E	ABC.....
Q	314	87-A30-097-010	TR, FN 1016	ABC.....
Q	313	87-A30-097-010	TR, FN 1016	ABC.....
Q	315	87-A30-098-010	TR, FP 1016	ABC.....
Q	316	87-A30-098-010	TR, FP 1016	ABC.....
Q	318	87-A30-106-070	C-TR, CMBT5551	ABC.....
Q	317	87-A30-106-070	C-TR, CMBT5551	ABC.....
Q	319	87-A30-162-010	FET, 2SK2937	ABC.....
Q	312	87-A30-190-080	TR, CC5551	ABC.....
Q	311	87-A30-190-080	TR, CC5551	ABC.....
Q	326	87-026-236-080	TR, DTC124E, K	ABC.....
Q	321	87-A30-072-080	C-TR, RT1P 144C	ABC.....
Q	323	87-A30-074-080	C-TR, RT1P 141C	.BC.....
Q	327	87-A30-075-080	C-TR, 2SA1235F	ABC.....
Q	325	87-A30-075-080	C-TR, 2SA1235F	ABC.....
Q	320	87-A30-162-010	FET, 2SK2937	ABC.....
Q	340	87-A30-107-070	C-TR, CMBT5401	ABC.....
Q	407	87-A30-097-010	TR, FN 1016	ABC.....
Q	408	87-A30-098-010	TR, FP 1016	ABC.....
Q	409	87-A30-106-070	C-TR, CMBT5551	ABC.....
Q	406	87-A30-190-080	TR, CC5551	ABC.....
Q	401	87-A30-257-080	C-TR, 2SD1306E	ABC.....
Q	417	87-026-236-080	TR, DTC124E, K	ABC.....
Q	412	87-A30-072-080	C-TR, RT1P 144C	ABC.....
Q	414	87-A30-074-080	C-TR, RT1P 141C	.BC.....
Q	416	87-A30-075-080	C-TR, 2SA1235F	ABC.....
Q	418	87-A30-075-080	C-TR, 2SA1235F	ABC.....
Q	413	87-A30-076-080	C-TR, 2SC3052F	ABC.....
Q	411	87-A30-162-010	FET, 2SK2937	ABC.....
Q	410	87-A30-162-010	FET, 2SK2937	ABC.....
Q	420	87-A30-076-080	C-TR, 2SC3052F	ABC.....
Q	421	87-A30-076-080	C-TR, 2SC3052F	ABC.....
Q	440	87-A30-107-070	C-TR, CMBT5401	ABC.....
R	281	87-A00-373-050	RES, M/F 270-1W J VTP	ABC.....
R	282	87-A00-373-050	RES, M/F 270-1W J VTP	ABC.....
R	283	87-A00-373-050	RES, M/F 270-1W J VTP	ABC.....
R	284	87-A00-373-050	RES, M/F 270-1W J VTP	ABC.....
R	416	87-A00-262-080	RES, M/F 0.15-2W J	AB.....
R	417	87-A00-262-080	RES, M/F 0.15-2W J	AB.....
R	417	87-A00-571-050	RES, M/F 0.15-2W J RZ	.C.....
R	416	87-A00-571-050	RES, M/F 0.15-2W J RZ	.C.....
R	424	87-A00-262-080	RES, M/F 0.15-2W J	AB.....
R	424	87-A00-571-050	RES, M/F 0.15-2W J RZ	.C.....
R	590	87-A00-262-080	RES, M/F 0.15-2W J	AB.....
R	590	87-A00-571-050	RES, M/F 0.15-2W J RZ	.C.....
R	611	87-A00-262-080	RES, M/F 0.15-2W J	AB.....
R	611	87-A00-571-050	RES, M/F 0.15-2W J RZ	.C.....
S	292	87-A90-174-010	SW, PUSH 2-2-2	ABC.....
S	291	87-A90-174-010	SW, PUSH 2-2-2	ABC.....
TH	202	87-A91-081-080	C-THMS, 100K-K 20P	.BC.....
TH	201	87-A91-081-080	C-THMS, 100K-K 20P	.BC.....
TH	302	87-A91-081-080	C-THMS, 100K-K 20P	.BC.....
TH	301	87-A91-081-080	C-THMS, 100K-K 20P	.BC.....
TH	401	87-A91-081-080	C-THMS, 100K-K 20P	.BC.....
C	609	87-010-188-080	CAP, CHIP 6800P	.C.....
C	602	87-010-378-080	CAP, ELECT 10-16V	.C.....
C	601	87-010-378-080	CAP, ELECT 10-16V	.C.....
C	605	87-010-405-080	CAP, ELECT 10-50V	ABC.....
C	606	87-010-405-080	CAP, ELECT 10-50V	ABC.....

ELECTRICAL MAIN PARTS LIST - 6

C	607	87-012-140-080	CAP 470P	..C.....
C	608	87-012-140-080	CAP 470P	..C.....
C	604	87-012-156-080	C-CAP,S 220P-50 CH	..C.....
C	603	87-012-156-080	C-CAP,S 220P-50 CH	..C.....
C	610	87-010-188-080	CAP,CHIP 6800P	..C.....
C	613	87-010-195-080	C-CAP,S 0.068-25 F	..C.....
C	612	87-010-195-080	C-CAP,S 0.068-25 F	..C.....
C	614	87-010-197-080	CAP, CHIP 0.01 DM	..C.....
C	611	87-010-197-080	CAP, CHIP 0.01 DM	..C.....
C	618	87-010-404-080	CAP, ELECT 4.7-50V	..C.....
C	617	87-010-404-080	CAP, ELECT 4.7-50V	..C.....
C	616	87-010-404-080	CAP, ELECT 4.7-50V	..C.....
C	619	87-010-404-080	CAP, ELECT 4.7-50V	..C.....
C	615	87-010-404-080	CAP, ELECT 4.7-50V	..C.....
C	620	87-010-101-080	CAP, ELECT 220-16	..C.....
D	602	87-A40-468-080	C-DIODE,HSM2836CTR	..C.....
D	601	87-A40-468-080	C-DIODE,HSM2836CTR	..C.....
IC	601	87-A20-056-010	IC,BA3880S	..C.....
C	701	87-010-260-080	CAP, ELECT 47-25V	ABC.....
C	702	87-010-404-080	CAP, ELECT 4.7-50V	ABC.....
C	709	87-012-195-080	C-CAP,U 100P-50CH	ABC.....
C	704	87-012-286-080	CAP, U 0.01-25	ABC.....
C	703	87-012-286-080	CAP, U 0.01-25	ABC.....
C	712	87-010-196-080	CHIP CAPACITOR,0.1-25	ABC.....
C	711	87-010-263-080	CAP, ELECT 100-10V	ABC.....
C	719	87-012-286-080	CAP, U 0.01-25	ABC.....
C	713	87-012-286-080	CAP, U 0.01-25	ABC.....
C	714	87-012-286-080	CAP, U 0.01-25	ABC.....
C	717	87-012-286-080	CAP, U 0.01-25	ABC.....
C	727	87-010-196-080	CHIP CAPACITOR,0.1-25	ABC.....
C	728	87-010-248-080	CAP, ELECT 220-10V	ABC.....
C	721	87-012-176-080	CAP 15P	ABC.....
C	722	87-012-176-080	CAP 15P	ABC.....
C	720	87-012-195-080	C-CAP,U 100P-50CH	ABC.....
C	725	87-012-274-080	CHIP CAP,U 1000P-50B	ABC.....
C	723	87-012-274-080	CHIP CAP,U 1000P-50B	ABC.....
D	721	87-A40-234-080	ZENER,MTZJ5.6A	ABC.....
IC	721	87-070-127-110	IC,LC72131 D	ABC.....
Q	711	87-A30-196-080	TR,2SC4115SRS	ABC.....
X	721	87-A70-061-010	VIB,XTAL 4.500MHZ CSA-309	ABC.....
C	758	87-012-167-080	C-CAP,U 5P-50 CH	ABC.....
C	757	87-012-188-080	C-CAP,U 47P-50 CH	ABC.....
C	753	87-012-195-080	C-CAP,U 100P-50CH	.B.....
C	761	87-010-196-080	CHIP CAPACITOR,0.1-25	ABC.....
C	769	87-010-260-080	CAP, ELECT 47-25V	ABC.....
C	764	87-012-337-080	C-CAP,U 56P-50 CH	A.C.....
C	774	87-010-263-080	CAP, ELECT 100-10V	ABC.....
C	771	87-010-383-080	CAP, ELECT 33-25V	ABC.....
C	777	87-010-400-080	CAP, ELECT 0.47-50V	ABC.....
C	778	87-010-401-080	CAP, ELECT 1-50V	ABC.....
C	779	87-010-401-080	CAP, ELECT 1-50V	ABC.....
C	775	87-010-404-080	CAP, ELECT 4.7-50V	ABC.....
C	770	87-010-829-080	CAP, U 0.047-16	ABC.....
C	773	87-015-785-080	CHIP CAPACITOR, 0.1FZ-25Z	.B.....
C	780	87-010-196-080	CHIP CAPACITOR,0.1-25	ABC.....
C	782	87-010-405-080	CAP, ELECT 10-50V	ABC.....
C	781	87-010-405-080	CAP, ELECT 10-50V	ABC.....
C	785	87-010-805-080	CAP, S 1-16	ABC.....
C	786	87-010-805-080	CAP, S 1-16	ABC.....
C	789	87-012-275-080	C-CAP,U 1200P-50 B	ABC.....
C	787	87-012-280-080	CAP, U 3300P-50	..C.....
C	788	87-012-280-080	CAP, U 3300P-50	..C.....
C	787	87-012-282-080	CAP, U 4700P-50	AB.....
C	788	87-012-282-080	CAP, U 4700P-50	AB.....
C	783	87-012-286-080	CAP, U 0.01-25	ABC.....
C	796	87-010-403-080	CAP, ELECT 3.3-50V	ABC.....
C	791	87-010-405-080	CAP, ELECT 10-50V	ABC.....
C	794	87-010-406-080	CAP, ELECT 22-50	ABC.....
C	795	87-010-596-080	CAP, S 0.047-16	A.C.....
C	793	87-012-273-080	C-CAP,U 820P-50 B	A.C.....
C	790	87-012-275-080	C-CAP,U 1200P-50 B	ABC.....
C	797	87-012-276-080	CAP, CHIP SS 1500 PBK	.BC.....
C	798	87-012-276-080	CAP, CHIP SS 1500 PBK	.BC.....
C	798	87-012-278-080	C-CAP,U 2200P-50 B	A.....
C	797	87-012-278-080	C-CAP,U 2200P-50 B	A.....
CN	601	87-099-028-010	CONN,11P 6216 H	ABC.....
D	773	87-020-465-080	DIODE,1SS133 (110MA)	A.....
IC	771	87-A20-913-010	IC,LA1837NL	ABC.....
L	771	87-A50-266-010	COIL,FM DET-2N(TOK)	ABC.....
L	772	87-A90-733-010	FLTR,PCFAZH-450 (TOK)	ABC.....
L	781	87-005-847-080	COIL,2.2UH(CECS)	ABC.....
L	792	87-A50-027-010	COIL,1 POLE MPX(TOK)	.BC.....
L	791	87-A50-027-010	COIL,1 POLE MPX(TOK)	.BC.....
L	792	87-A50-209-010	COIL,1POLE MPX(MIT)	A.....
L	791	87-A50-209-010	COIL,1POLE MPX(MIT)	A.....
C	859	87-012-286-080	CAP, U 0.01-25	.B.....
C	865	87-010-196-080	CHIP CAPACITOR,0.1-25	.B.....
C	864	87-010-405-080	CAP, ELECT 10-50V	.B.....
C	866	87-010-405-080	CAP, ELECT 10-50V	.B.....
C	869	87-012-180-080	C-CAP,U 22P-50 CH	.B.....
C	868	87-012-184-080	C-CAP,U 33P-50 CH	.B.....
C	861	87-012-199-080	CAP 220P	.B.....
C	862	87-012-199-080	CAP 220P	.B.....

ELECTRICAL MAIN PARTS LIST - 7

C	863	87-012-270-080	CAP, U 470P-50	.B.....
C	867	87-012-286-080	CAP, U 0.01-25	.B.....
CN	602	87-099-211-010	CONN, 4P 6216V	.B.....
IC	851	87-A20-440-040	C-IC, BU1920FS	.B.....
L	851	87-005-847-080	COIL, 2.2UH(CECS)	.B.....
Q	853	87-A30-076-080	C-TR, 2SC3052F	.B.....
X	851	87-A70-091-010	VIB, XTAL 4.332MHZ CSA-309	.B.....
C	813	87-010-197-080	CAP, CHIP 0.01 DM	A.C.....
C	819	87-010-197-080	CAP, CHIP 0.01 DM	A.C.....
C	812	87-012-286-080	CAP, U 0.01-25	ABC.....
C	814	87-012-286-080	CAP, U 0.01-25	ABC.....
C	828	87-010-196-080	CHIP CAPACITOR, 0.1-25	ABC.....
C	829	87-010-196-080	CHIP CAPACITOR, 0.1-25	ABC.....
C	820	87-010-260-080	CAP, ELECT 47-25V	ABC.....
C	823	87-012-286-080	CAP, U 0.01-25	ABC.....
C	822	87-012-286-080	CAP, U 0.01-25	ABC.....
C	821	87-012-286-080	CAP, U 0.01-25	ABC.....
C	942	87-012-172-080	CAPACITOR CHIP U 10P CH	.B.....
C	949	87-A10-039-080	C-CAP, U 470P-50 J CH	.B.....
C	959	87-010-196-080	CHIP CAPACITOR, 0.1-25	ABC.....
C	960	87-010-196-080	CHIP CAPACITOR, 0.1-25	ABC.....
C	962	87-010-401-080	CAP, ELECT 1-50V	.B.....
C	961	87-012-170-080	C-CAP, U 8P-50 CH	.C.....
C	961	87-012-174-080	CAP CHIP CERA SS 12P CHJ	A.....
CF	802	82-785-747-010	CF MS2 GHY R	.B.....
CF	801	87-008-261-010	FILTER, SFE10.7MA5-A	A.C.....
CF	802	87-008-261-010	FILTER, SFE10.7MA5-A	A.C.....
CF	801	87-008-423-010	CERAMIC FILTER, SFE10.7	.B.....
D	942	87-A40-270-080	C-DIODE, MC2838	.B.....
FFE	801	A8-6ZA-191-130	6ZA-1 FEENM	.B.....
FFE	801	A8-8ZA-190-030	8ZA-1 FEUNM	A.C.....
J	802	87-033-241-010	TERMINAL, ANT AJ-2039	.B.....
J	801	87-A60-657-010	TERMINAL, 4P HSP-154V5-02	A.C.....
L	832	87-005-847-080	COIL, 2.2UH(CECS)	ABC.....
L	942	87-A50-019-010	COIL, OSC LW(COI)	.B.....
L	941	87-A50-020-010	COIL, ANT LW(COI)	.B.....
L	981	87-NF4-650-010	COIL, AM PACK 4N(TOK)	A.C.....
L	981	87-NF4-651-110	COIL, AM PACK2N(TOM)	.B.....
Q	806	87-A30-072-080	C-TR, RT1P 144C	ABC.....
Q	805	89-327-143-080	TR, 2SC2714 (0.1W)	ABC.....
Q	948	87-A30-086-070	C-TR, CSD1306E	.B.....
Q	947	89-503-602-080	C-FET, 2SK360E	.B.....
Q	951	87-A30-074-080	C-TR, RT1P 141C	.B.....
Q	952	87-A30-086-070	C-TR, CSD1306E	.B.....
TC	942	87-011-164-010	CAPACITOR, TRIMMER 30P	.B.....
C	801	87-010-176-080	C-CAP, S 680P-50 SL	ABC.....
C	802	87-010-176-080	C-CAP, S 680P-50 SL	ABC.....
C	808	87-010-405-080	CAP, ELECT 10-50V	.C.....
C	807	87-010-405-080	CAP, ELECT 10-50V	.C.....
C	806	87-010-949-080	CHIP CAPACITOR, S 0.01-50 BJ	ABC.....
C	803	87-010-949-080	CHIP CAPACITOR, S 0.01-50 BJ	ABC.....
C	805	87-010-949-080	CHIP CAPACITOR, S 0.01-50 BJ	ABC.....
C	804	87-010-949-080	CHIP CAPACITOR, S 0.01-50 BJ	ABC.....
C	809	87-016-081-080	C-CAP, S 0.1-16 RK	ABC.....
C	810	87-010-112-080	CAP, ELECT 100-16V	ABC.....
C	819	87-010-188-080	CAP, CHIP 6800P	ABC.....
C	817	87-010-221-080	CAP, ELECT 470-10V	ABC.....
C	813	87-010-400-080	CAP, ELECT 0.47-50V	ABC.....
C	812	87-010-401-080	CAP, ELECT 1-50V	ABC.....
C	811	87-010-401-080	CAP, ELECT 1-50V	ABC.....
C	812	87-010-402-080	CAP, ELECT 2.2-50V	AB.....
C	811	87-010-402-080	CAP, ELECT 2.2-50V	AB.....
C	818	87-010-404-080	CAP, ELECT 4.7-50V	ABC.....
C	816	87-010-546-080	CAP, ELECT 0.33-50V	ABC.....
C	815	87-010-546-080	CAP, ELECT 0.33-50V	ABC.....
C	827	87-010-166-080	C-CAP, S 100P-50 SL	ABC.....
C	826	87-010-166-080	C-CAP, S 100P-50 SL	ABC.....
C	828	87-010-166-080	C-CAP, S 100P-50 SL	ABC.....
C	823	87-010-263-080	CAP, ELECT 100-10V	ABC.....
C	824	87-010-374-080	CAP, ELECT 47-10V	ABC.....
C	829	87-010-544-080	CAP, ELECT 0.1-50V	ABC.....
C	825	87-016-081-080	C-CAP, S 0.1-16 RK	ABC.....
C	821	87-016-081-080	C-CAP, S 0.1-16 RK	ABC.....
C	822	87-016-083-080	C-CAP, S 0.15-16 RK	ABC.....
C	830	87-010-546-080	CAP, ELECT 0.33-50V	ABC.....
C	831	87-010-971-080	C-CAP, S 4700P-50 B J	ABC.....
C	837	87-010-971-080	C-CAP, S 4700P-50 B J	ABC.....
C	832	87-012-349-080	C-CAP, S 1000P-50 CH	ABC.....
C	838	87-012-349-080	C-CAP, S 1000P-50 CH	ABC.....
C	845	87-012-393-080	C-CAP, S 0.22-16 R K	ABC.....
C	849	87-012-393-080	C-CAP, S 0.22-16 R K	ABC.....
C	848	87-012-393-080	C-CAP, S 0.22-16 R K	ABC.....
C	844	87-012-393-080	C-CAP, S 0.22-16 R K	ABC.....
C	843	87-A10-229-080	C-CAP, S 0.68-10 K W5	ABC.....
C	841	87-A10-799-080	C-CAP, S 5600P-16 J B CM	ABC.....
C	842	87-A10-802-080	C-CAP, S 0.047-16 J B CM	ABC.....
C	856	87-A10-801-080	C-CAP, S 0.022-16 J B CM	ABC.....
C	855	87-A10-801-080	C-CAP, S 0.022-16 J B CM	ABC.....
C	852	87-A10-802-080	C-CAP, S 0.047-16 J B CM	ABC.....
C	851	87-A10-802-080	C-CAP, S 0.047-16 J B CM	ABC.....
C	869	87-010-166-080	C-CAP, S 100P-50 SL	ABC.....
C	862	87-010-263-080	CAP, ELECT 100-10V	ABC.....
C	864	87-010-263-080	CAP, ELECT 100-10V	ABC.....

ELECTRICAL MAIN PARTS LIST - 8

C	866	87-010-749-080	CAP, S 0.047-25 B	AB.....
C	861	87-016-081-080	C-CAP, S 0.1-16 RK	ABC.....
C	863	87-016-081-080	C-CAP, S 0.1-16 RK	ABC.....
C	868	87-A10-060-080	C-CAP, S 0.18-16 K B	ABC.....
C	867	87-A10-201-080	C-CAP, S0.33-16 KB	ABC.....
C	870	87-010-166-080	C-CAP, S 100P-50 SL	ABC.....
C	871	87-010-166-080	C-CAP, S 100P-50 SL	ABC.....
CN	801	87-099-556-010	CONN, 10P TUC-P10X-B1	ABC.....
CN	802	87-099-559-010	CONN, 13P TUC-P13X-B1	ABC.....
D	802	87-070-136-080	ZENER, MTZJ5.1B	ABC.....
D	803	87-A40-438-080	ZENER, MTZJ4.7A	ABC.....
D	804	87-A40-438-080	ZENER, MTZJ4.7A	ABC.....
D	801	87-A40-442-080	ZENER, MTZJ9.1A	ABC.....
IC	801	87-A21-097-040	C-IC, M62463AFP	ABC.....
IC	831	87-A21-015-040	C-IC, M62491FP	ABC.....
Q	834	87-A30-076-080	C-TR, 2SC3052F	ABC.....
R	807	87-022-365-080	C-RES, S 100K-1/10W F	ABC.....
C	702	87-010-196-080	CHIP CAPACITOR, 0.1-25	ABC.....
C	701	87-010-196-080	CHIP CAPACITOR, 0.1-25	ABC.....
IC	701	87-020-784-080	IC, TC4053BF	ABC.....
C	906	87-010-260-080	CAP, ELECT 47-25V	ABC.....
C	909	87-010-371-080	CAP, ELECT 470-6.3V	ABC.....
C	908	87-010-387-080	CAP, E 470-25 SME	ABC.....
C	901	87-010-406-080	CAP, ELECT 22-50	ABC.....
C	905	87-010-406-080	CAP, ELECT 22-50	ABC.....
C	903	87-010-406-080	CAP, ELECT 22-50	ABC.....
C	902	87-010-406-080	CAP, ELECT 22-50	ABC.....
C	904	87-010-406-080	CAP, ELECT 22-50	ABC.....
C	912	87-010-196-080	CHIP CAPACITOR, 0.1-25	ABC.....
C	910	87-010-371-080	CAP, ELECT 470-6.3V	ABC.....
C	911	87-010-371-080	CAP, ELECT 470-6.3V	ABC.....
C	954	87-010-322-080	C-CAP, S 100P-50 CH	.B.....
C	953	87-010-322-080	C-CAP, S 100P-50 CH	.B.....
C	952	87-010-322-080	C-CAP, S 100P-50 CH	.B.....
C	951	87-010-322-080	C-CAP, S 100P-50 CH	.B.....
D	902	87-020-465-080	DIODE, 1SS133 (110MA)	ABC.....
D	901	87-070-136-080	ZENER, MTZJ5.1B	ABC.....
D	903	87-A40-291-080	DIODE, 1N4148 (CPT)	ABC.....
IC	902	87-017-917-080	IC, BU4066BCF	ABC.....
IC	901	87-A20-820-010	IC, BA7625	ABC.....
J	903	87-099-911-010	JACK, PIN 3P YEL	ABC.....
J	901	87-099-911-010	JACK, PIN 3P YEL	ABC.....
J	904	87-099-911-010	JACK, PIN 3P YEL	ABC.....
J	905	87-099-911-010	JACK, PIN 3P YEL	ABC.....
J	902	87-099-912-010	JACK, PIN 3P YEL W/E	ABC.....
L	901	87-005-239-080	COIL, 100UH	ABC.....
Q	906	87-A30-074-080	C-TR, RT1P 141C	ABC.....
Q	901	87-A30-075-080	C-TR, 2SA1235F	ABC.....
Q	903	87-A30-075-080	C-TR, 2SA1235F	ABC.....
Q	907	87-A30-075-080	C-TR, 2SA1235F	ABC.....
Q	902	87-A30-075-080	C-TR, 2SA1235F	ABC.....
Q	904	87-A30-076-080	C-TR, 2SC3052F	ABC.....
Q	905	87-A30-076-080	C-TR, 2SC3052F	ABC.....
R	905	87-010-317-080	C-CAP, S 39P-50 CH	.C.....
C	102	87-010-186-080	CAP, CHIP 4700P	ABC.....
C	101	87-018-131-080	CAP, CER 1000P-50V	ABC.....
C	504	87-010-188-080	CAP, CHIP 6800P	ABC.....
C	503	87-010-188-080	CAP, CHIP 6800P	ABC.....
C	502	87-018-209-080	CAP, CER 0.1-50V	ABC.....
C	501	87-018-209-080	CAP, CER 0.1-50V	ABC.....
C	507	87-018-209-080	CAP, CER 0.1-50V	ABC.....
C	651	87-010-178-080	CHIP CAP 1000P	.B.....
C	652	87-010-178-080	CHIP CAP 1000P	.B.....
CN	401	87-099-758-010	CONN, 17P H 9604	ABC.....
D	503	87-020-465-080	DIODE, 1SS133 (110MA)	ABC.....
D	504	87-020-465-080	DIODE, 1SS133 (110MA)	ABC.....
D	502	87-020-465-080	DIODE, 1SS133 (110MA)	ABC.....
D	501	87-020-465-080	DIODE, 1SS133 (110MA)	ABC.....
D	505	87-020-465-080	DIODE, 1SS133 (110MA)	ABC.....
D	506	87-020-465-080	DIODE, 1SS133 (110MA)	ABC.....
FB	501	87-008-372-080	FILTER, EMI BL OIRNI	ABC.....
FB	602	87-008-372-080	FILTER, EMI BL OIRNI	ABC.....
J	501	87-A60-606-010	JACK, PIN 3P R/W/Y W/O SW H	ABC.....
J	603	87-A60-550-010	JACK, DIA6.3 BLK ST W/SW KM	ABC.....
LED	401	87-A40-317-080	LED, SLR-342VCT31 RED	ABC.....
S	403	87-A90-095-080	SW, TACT EVQ11G04M	ABC.....
S	401	87-A90-095-080	SW, TACT EVQ11G04M	ABC.....
S	402	87-A90-095-080	SW, TACT EVQ11G04M	ABC.....
SW	401	87-A91-373-010	SW, RTRY EC16B1220408	ABC.....
C	723	87-010-401-080	CAP, ELECT 1-50V	ABC.....
C	726	87-010-401-080	CAP, ELECT 1-50V	ABC.....
Q	721	87-A30-086-070	C-TR, CSD1306E	ABC.....
CN	509	87-099-667-010	CONN, 8P TUC-P8P-B1	.C.....
CN	504	87-099-567-010	CONN, 10P TUC-P10P-B1	ABC.....
CN	505	87-099-570-010	CONN, 13P TUC-P13P-B1	ABC.....
C	1	87-012-368-080	C-CAP, S 0.1-50 F	.C.....
C	712	87-010-322-080	C-CAP, S 100P-50 CH	.B.....
C	714	87-010-322-080	C-CAP, S 100P-50 CH	.B.....
C	715	87-010-322-080	C-CAP, S 100P-50 CH	.B.....
C	710	87-010-322-080	C-CAP, S 100P-50 CH	.B.....
C	711	87-010-322-080	C-CAP, S 100P-50 CH	.B.....
C	713	87-010-322-080	C-CAP, S 100P-50 CH	.B.....
C	750	87-010-196-080	CHIP CAPACITOR, 0.1-25	ABC.....

ELECTRICAL MAIN PARTS LIST -9

J	750	87-A60-660-010	JACK,PIN 6P W/R,W/R, B/O(G)	ABC.....
C	131	87-010-378-080	CAP, ELECT 10-16V	ABC.....
C	133	87-010-378-080	CAP, ELECT 10-16V	ABC.....
C	135	87-012-368-080	C-CAP,S 0.1-50 F	ABC.....
C	136	87-012-368-080	C-CAP,S 0.1-50 F	ABC.....
IC	101	87-017-888-080	IC,NJM4558MD	ABC.....
C	659	87-010-177-080	C-CAP,S 820P-50 SL	..C.....
C	654	87-010-183-080	C-CAP,S 2700P-50 B	..C.....
C	657	87-010-183-080	C-CAP,S 2700P-50 B	..C.....
C	652	87-010-196-080	CHIP CAPACITOR,0.1-25	..C.....
C	655	87-010-196-080	CHIP CAPACITOR,0.1-25	..C.....
C	658	87-012-145-080	CAP, CHIP S 270P CH	..C.....
C	653	87-012-154-080	C-CAP,S 150P-50 CH	..C.....
C	656	87-012-154-080	C-CAP,S 150P-50 CH	..C.....
C	671	87-010-177-080	C-CAP,S 820P-50 SL	..C.....
C	672	87-010-196-080	CHIP CAPACITOR,0.1-25	..C.....
C	673	87-010-196-080	CHIP CAPACITOR,0.1-25	..C.....
C	674	87-010-196-080	CHIP CAPACITOR,0.1-25	..C.....
C	675	87-010-263-080	CAP, ELECT 100-10V	..C.....
C	676	87-010-374-080	CAP, ELECT 47-10V	..C.....
C	670	87-012-145-080	CAP, CHIP S 270P CH	..C.....
CN	508	87-099-669-010	CONN,8P TUC-P8X-B1	..C.....
D	650	87-070-136-080	ZENER,MTZJ5.1B	..C.....
IC	650	87-A20-561-040	C-IC,M65847AFP	..C.....
C	758	87-010-404-080	CAP, ELECT 4.7-50V	ABC.....
C	759	87-012-368-080	C-CAP,S 0.1-50 F	ABC.....
C	766	87-010-181-080	CAP,CHIP S 1800P	ABC.....
C	764	87-010-185-080	C-CAP,S 3900P-50 B	ABC.....
C	769	87-010-188-080	CAP,CHIP 6800P	ABC.....
C	765	87-010-194-080	CAP, CHIP 0.047	ABC.....
C	762	87-010-197-080	CAP, CHIP 0.01 DM	ABC.....
C	761	87-010-198-080	CAP, CHIP 0.022	ABC.....
C	767	87-010-198-080	CAP, CHIP 0.022	ABC.....
C	768	87-010-994-080	C-CAP,S 680P-50 CH	ABC.....
C	776	87-010-181-080	CAP,CHIP S 1800P	ABC.....
C	771	87-010-183-080	C-CAP,S 2700P-50 B	ABC.....
C	778	87-010-185-080	C-CAP,S 3900P-50 B	ABC.....
C	777	87-010-194-080	CAP, CHIP 0.047	ABC.....
C	775	87-010-198-080	CAP, CHIP 0.022	ABC.....
C	774	87-010-994-080	C-CAP,S 680P-50 CH	ABC.....
C	772	87-012-145-080	CAP, CHIP S 270P CH	ABC.....
C	770	87-012-145-080	CAP, CHIP S 270P CH	ABC.....
C	782	87-010-183-080	C-CAP,S 2700P-50 B	ABC.....
C	780	87-010-197-080	CAP, CHIP 0.01 DM	ABC.....
C	783	87-010-198-080	CAP, CHIP 0.022	ABC.....
C	789	87-010-260-080	CAP, ELECT 47-25V	ABC.....
C	788	87-010-260-080	CAP, ELECT 47-25V	ABC.....
C	786	87-010-402-080	CAP, ELECT 2.2-50V	ABC.....
C	787	87-010-402-080	CAP, ELECT 2.2-50V	ABC.....
C	790	87-010-260-080	CAP, ELECT 47-25V	ABC.....
C	799	87-010-322-080	C-CAP,S 100P-50 CH	ABC.....
C	797	87-010-322-080	C-CAP,S 100P-50 CH	ABC.....
C	798	87-010-322-080	C-CAP,S 100P-50 CH	ABC.....
C	791	87-010-405-080	CAP, ELECT 10-50V	ABC.....
C	792	87-010-405-080	CAP, ELECT 10-50V	ABC.....
C	794	87-012-368-080	C-CAP,S 0.1-50 F	ABC.....
C	793	87-012-368-080	C-CAP,S 0.1-50 F	ABC.....
CN	701	87-099-557-010	CONN,11P TUC-P11X-B1	ABC.....
D	722	87-A40-002-080	ZENER,MTZJ5.1C	ABC.....
D	723	87-A40-344-080	ZENER,MTZJ6.2C	ABC.....
D	721	87-A40-344-080	ZENER,MTZJ6.2C	ABC.....
IC	701	87-A20-437-010	C-IC,M62431FP	ABC.....
C	608	87-010-186-080	CAP,CHIP 4700P	..C.....
C	609	87-010-188-080	CAP,CHIP 6800P	..C.....
C	607	87-010-196-080	CHIP CAPACITOR,0.1-25	..C.....
C	601	87-010-196-080	CHIP CAPACITOR,0.1-25	..C.....
C	606	87-010-321-080	CHIP CAPACITOR,82P(J)	..C.....
C	605	87-010-322-080	C-CAP,S 100P-50 CH	..C.....
C	603	87-010-491-040	CAP,E 0.22-50 GAS	..C.....
C	602	87-010-560-040	CAP,E 10-50 GAS	..C.....
C	604	87-A10-189-040	CAP,E 220-10	..C.....
C	612	87-010-177-080	C-CAP,S 820P-50 SL	..C.....
C	611	87-010-322-080	C-CAP,S 100P-50 CH	..C.....
C	613	87-010-552-040	CAP,E 22-16 GAS	..C.....
C	610	87-010-560-040	CAP,E 10-50 GAS	..C.....
C	614	87-015-695-040	E/CAP 1UF 50V TAPG	..C.....
CN	601	87-009-362-010	CONN,6P,BTMK P-1R	..C.....
D	601	87-020-465-080	DIODE,1SS133 (110MA)	..C.....
FB	601	87-008-372-080	FILTER, EMI BL OIRNI	..C.....
IC	601	87-017-888-080	IC,NJM4558MD	..C.....
J	601	87-A60-188-010	JACK,6.3 BLK MONO W/SW MIC	..C.....
J	602	87-A60-188-010	JACK,6.3 BLK MONO W/SW MIC	..C.....
Q	601	87-A30-087-080	C-FET,2SK2158	..C.....
C	1	87-010-387-080	CAP,E 470-25 SME	AB.....
C	2	87-010-403-080	CAP, ELECT 3.3-50V	AB.....
C	7	87-A10-922-090	CAP,CER 0.01-250 M F KH	AB.....
C	141	87-012-368-080	C-CAP,S 0.1-50 F	..B.....
C	141	87-018-209-080	CAP, CER 0.1-50V	AB.....
CN	103	87-A60-851-010	CONN,9P V VH	AB.....
CN	101	88-805-042-690	CONN ASSY,4P	AB.....
D	4	87-020-465-080	DIODE,1SS133 (110MA)	AB.....
D	2	87-020-465-080	DIODE,1SS133 (110MA)	AB.....
D	7	87-020-465-080	DIODE,1SS133 (110MA)	AB.....

ELECTRICAL MAIN PARTS LIST - 10

D	5	87-020-465-080	DIODE, 1SS133 (110MA)	AB.....
D	6	87-020-465-080	DIODE, 1SS133 (110MA)	AB.....
D	3	87-020-465-080	DIODE, 1SS133 (110MA)	AB.....
D	1	87-020-465-080	DIODE, 1SS133 (110MA)	AB.....
FC	101	87-A90-160-080	FUSE CLAMP, FC 51F	AB.....
FC	102	87-A90-160-080	FUSE CLAMP, FC 51F	AB.....
PR	1	87-A91-276-080	FUSE, 125MA 125V F 251	A.....
PR	106	87-026-691-080	FUSE, 10A 125V 251	A.....
PR	105	87-026-691-080	FUSE, 10A 125V 251	A.....
PR	106	87-A90-195-080	PROTECTOR 7A 125V 49	.B.....
PR	105	87-A90-195-080	PROTECTOR 7A 125V 49	.B.....
PR	116	87-A90-195-080	PROTECTOR 7A 125V 49	.B.....
PR	115	87-A90-195-080	PROTECTOR 7A 125V 49	.B.....
PT	2	8Z-NF8-661-010	PT, SUB ZNF-8 (U)	A.....
PT	2	8Z-NF8-662-010	PT, SUB ZNF-8 (E)	.B.....
Q	2	87-026-245-080	TR, DTC114ES	AB.....
Q	1	87-A30-197-080	TR, KTA1267GR	AB.....
Q	3	87-A30-198-080	TR, KTC3199GR	AB.....
RY	1	87-A90-977-010	RELAY, AC12V DG12D1-O (M)	AB.....
T	2	87-A60-317-010	TERMINAL, 1P MSC	AB.....
T	1	87-A60-317-010	TERMINAL, 1P MSC	AB.....
C	1	87-010-387-010	CAP, ELECT 25-470SME	.C.....
C	2	87-010-403-080	CAP, ELECT 3.3-50V	.C.....
C	4	87-018-209-080	CAP, CER 0.1-50V	.C.....
C	3	87-018-209-080	CAP, CER 0.1-50V	.C.....
C	7	87-A10-922-090	CAP, CER 0.01-250 M F KH	.C.....
C	8	87-A10-922-090	CAP, CER 0.01-250 M F KH	.C.....
C	13	87-018-209-080	CAP, CER 0.1-50V	.C.....
CN	103	87-A60-851-010	CONN, 9P V VH	.C.....
CN	101	88-805-042-690	CONN ASSY, 4P	.C.....
D	1	87-020-465-080	DIODE, 1SS133 (110MA)	.C.....
D	3	87-020-465-080	DIODE, 1SS133 (110MA)	.C.....
D	2	87-020-465-080	DIODE, 1SS133 (110MA)	.C.....
D	5	87-020-465-080	DIODE, 1SS133 (110MA)	.C.....
D	6	87-020-465-080	DIODE, 1SS133 (110MA)	.C.....
D	4	87-020-465-080	DIODE, 1SS133 (110MA)	.C.....
D	7	87-020-465-080	DIODE, 1SS133 (110MA)	.C.....
PR	106	87-026-682-080	PROTECTOR, 10A 60V491	.C.....
PR	105	87-026-682-080	PROTECTOR, 10A 60V491	.C.....
PT	2	8Z-NF8-663-010	PT, SUB ZNF-8 (H)	.C.....
Q	2	87-026-245-080	TR, DTC114ES	.C.....
Q	1	87-A30-197-080	TR, KTA1267GR	.C.....
Q	3	87-A30-198-080	TR, KTC3199GR	.C.....
RY	1	87-A90-454-010	RELAY, 12V DJ12D2-O (M)	.C.....
FC	101	87-033-147-010	FUSE CLAMP	.C.....
FC	104	87-033-147-010	FUSE CLAMP	.C.....
FC	102	87-033-147-010	FUSE CLAMP	.C.....
FC	103	87-033-147-010	FUSE CLAMP	.C.....
SW	101	87-A90-165-010	SW, SL 1-2-3 SWS2301	.C.....
T	101	87-A60-317-010	TERMINAL, 1P MSC	.C.....
T	102	87-A60-317-010	TERMINAL, 1P MSC	.C.....
CN	202	87-009-663-010	CONN, 6P VH V	.C.....
CN	201	87-099-799-010	CONN, 8P B8P-VH	.C.....
J	901	87-033-211-010	TERMINAL, 8P SPKR0820	.C.....
J	902	87-A60-965-010	TERMINAL, SP 6P LTS0620	.C.....

MECHANICAL PARTS LIST - 1

NOTE: The characters in the suffix column indicate the part usage.

REF.NO	PARTS NO.	NO.	DESCRIPTION	SUFFIX	
EZ	XX	B	
	82-NE6-067-010		BADGE, AIWA 30N	ABC	
	8Z-AR1-003-010		CABI, STEEL	ABC	
	8Z-AR1-020-010		RING, FOOT SIL	AB	
	8Z-AR1-020-110		RING, FOOT SIL	.C	
	8Z-AR1-021-010		FOOT, REAR	AB	
	8Z-AR1-021-110		FOOT, REAR	.C	
	8Z-AR1-033-010		PANEL, FR EZ	.B	
	8Z-AR3-012-010		PANEL, FR	A	
	8Z-AR3-013-010		PANEL, FR HR	.C	
	8Z-AR3-014-010		PANEL, FR EZ		
	8Z-AR4-001-010		PANEL, REAR UBNM	A	
	8Z-AR4-002-010		PANEL, REAR EZBNM	.B	
	8Z-AR4-004-010		PANEL, REAR HCBNM	.C	
	8Z-AR4-007-010		CABI, FR U	A	
	8Z-AR4-008-010		CABI, FR HC	.C	
	8Z-AR4-009-010		CABI, FR EZ	.B	
	8Z-AR1-004-010		KEY, POWER	ABC	
	8Z-AR1-005-010		KEY, GEQ	ABC	
	8Z-AR1-006-010		KEY, DIGITAL	ABC	
	8Z-AR1-007-010		KEY, ENTER	ABC	
	8Z-AR1-009-010		KEY, MIC	.C	
	8Z-AR1-010-010		BTN, SP	ABC	
	8Z-AR1-011-010		KNOB, RTRY VOL	ABC	
	8Z-AR1-012-010		KNOB, RTRY FUN	ABC	
	8Z-AR1-013-010		KNOB, RTRY JOG	ABC	
	8Z-AR1-018-010		KEY, BBE	.C	
	8Z-AR1-019-010		KEY, MONITOR	ABC	
	8Z-AR1-030-010		KEY, RDS	.B	
	8Z-AR1-031-010		KEY, BALANCE	AB	
	8Z-AR1-015-010		REFLECTOR, FUN	ABC	
	8Z-AR1-016-010		REFLECTOR, ECO	ABC	
	8Z-AR1-017-010		RING, VOL	ABC	
	8Z-AR3-005-010		WINDOW, DISPLAY 5.1CH	ABC	
	87-033-209-010		TERMINAL, EARTH	ABC	
	88-AR1-203-010		HLDR, TU	ABC	
	88-AR1-211-110		HLDR, AC SW	.C	
	88-AR1-218-010		HLDR, PWB H8.9	ABC	
	88-AR2-205-110		HLDR, PWB OSD	.C	
	8Z-AR1-205-010		HLDR, HT-SINK	ABC	
	8Z-AR1-210-010		HLDR, PT PWB	ABC	
	8Z-AR1-219-010		HLDR, PWB PRO	ABC	
	8Z-NB8-240-010		COVER, PL	ABC	
	87-067-581-010		TAPPING SCREW, BVT2+3-15	ABC	
	87-067-584-010		TAPPING SCREW, BVT2+3-6	ABC	
	87-067-585-010		TAPPING SCREW, BVTT+4-6	.C	
	87-067-632-010		TAPPING SCREW, BVT2+3-15	.C	
	87-067-633-010		TAPPING SCREW, BVT2+3-8	.C	
	87-067-641-010		UTT2+3-8 (W/O SLOT)BL	ABC	
	87-067-689-010		TAPPING SCREW, BVTT+3-8	.C	
	87-067-703-010		TAPPING SCREW, BVT2+3-10	ABC	
	87-067-752-010		BVTT+4-10	AB	
	87-067-761-010		TAPPING SCREW, BVT2+3-10	.C	
	87-067-975-010		S-SCREW, IT+4-8	.C	
	87-078-191-010		S-SCREW, IT+4-10	.C	
	87-591-095-410		TAPPING SCREW, QIT+3-8 (GLD)	ABC	
	87-014-041-880		CAP, PP 220P-100J	AB	
	87-050-079-010		AC-CORD ASSY, E	.B	
	87-085-185-010		BUSHING, AC CORD (E)	.BC	
	87-085-189-010		BUSHING, CORD (U)	A	
	87-A80-083-010		AC CORD, HC BLK	.C	
	87-A80-110-010		AC CORD ASSY, U SPT-2W	A	
	88-904-181-110		FF-CABLE, 4P 1.25	.B	
	88-911-161-110		FF-CABLE, 11P 1.25	ABC	
	88-917-101-210		FF-CABLE, 17P 1.25	ABC	
	8Z-AR1-603-010		FF-CABLE, 32P 1.25 400MM	A.C	
	8Z-AR1-604-010		FF-CABLE, 35P 1.25 400MM	.B	
	8Z-AR1-641-010		FF-CABLE, 6P 1.25 340MM	.C	
	8Z-AR4-601-010		PT, ZAR-4 (U)	A	
	8Z-AR4-602-010		PT, ZAR-4 (HC)	.C	
	8Z-AR4-603-010		PT, ZAR-4 (EZ)	.B	
D	113		87-020-465-080	DIODE, 1SS133 (110MA)	.C
F	102		87-035-458-010	FUSE, 4A 250V T W/C	.BC
F	101		87-035-493-010	FUSE, 8A 125V	A
			88-NF6-205-010	GUIDE, FL 40-150- 9	ABC
			87-067-579-010	TAPPING SCREW, BVT2+3-8	ABC
W	3		8Z-NF3-645-010	CONN ASSY, 9P VH	ABC
WH	101		87-A90-510-010	HLDR, WIRE 2.5-9P	ABC
			87-067-579-010	TAPPING SCREW, BVT2+3-8	.C
			87-067-703-010	TAPPING SCREW, BVT2+3-10	AB

ACCESSORIES LIST

NOTE: The characters in the suffix column indicate the part usage.

REF.NO	PARTS NO.	NO.	DESCRIPTION	SUFFIX
EZ		XX		B
	8Z-AR4-901-010		IB, H(EC-K)M	.C
	8Z-AR4-903-010		IB, U(ESF)M	A
	8Z-AR4-903-110		IB, U(ESF)M	
	8Z-AR4-906-010		IB, EZ(9L)M	.B
	87-006-225-010		AM LOOP ANT NC2	ABC
	87-043-106-010		WIRE, FM ANT (Z)	.B
	87-043-115-010		ANT, FEEDER FM	A.C
	87-099-789-010		PLUG, ADPTR IR44	.C
	8Z-AR1-702-010		RC UNIT, RC-ZAR01	.C
	8Z-AR3-702-010		RC UNIT, RC-ZAR02	AB

SCHEMATIC DIAGRAM - 1 (MAIN)

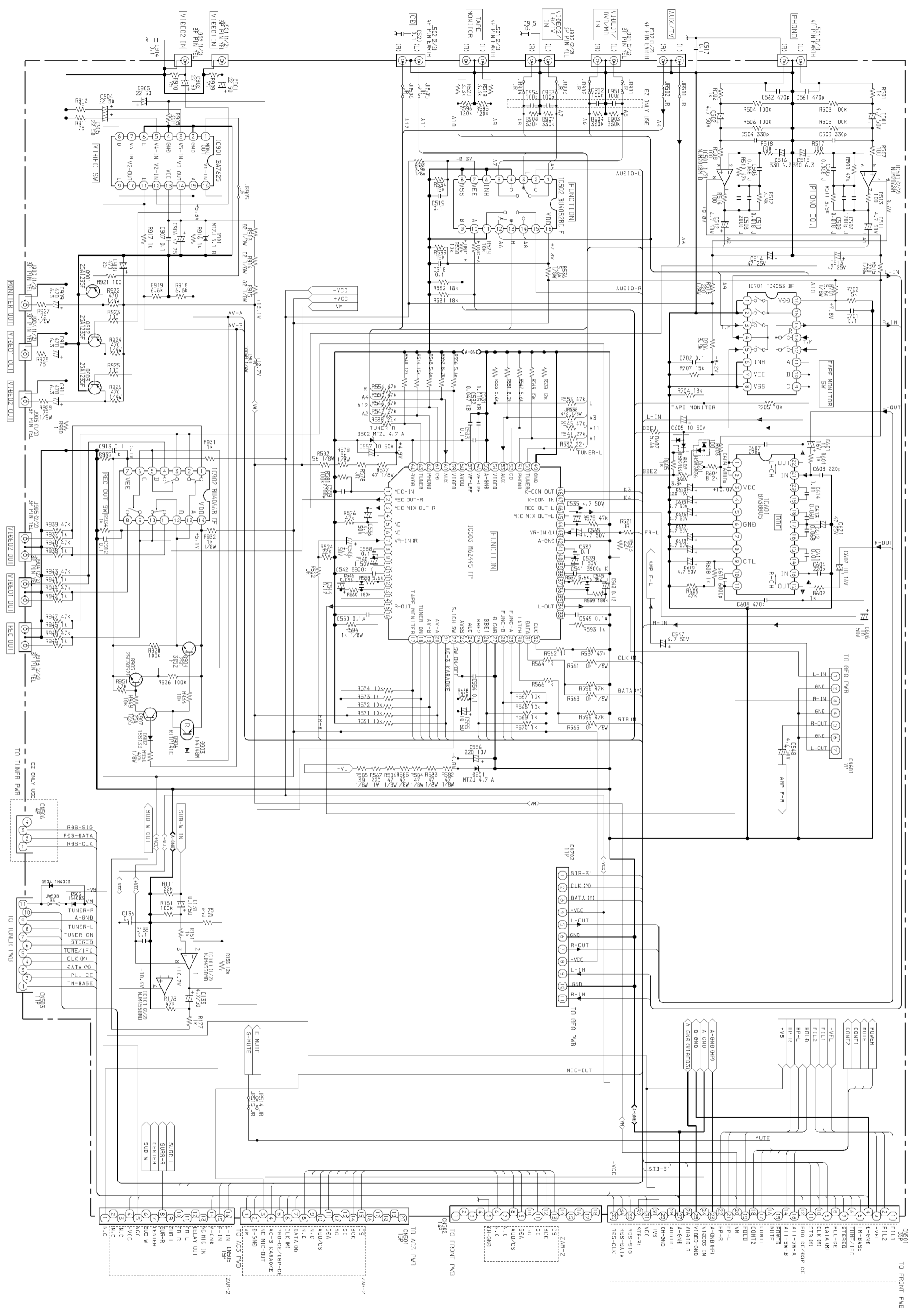

SCHEMATIC DIAGRAM - 2 (FRONT)

DIODE MATRIX

ZAR-1/2/3/4	U	HR/HC	EZ	LH	B
B1T3	U	HR/HC	EZ	LH	B
B1T2	FH1	-/-/-	-/-/-	-/-/-	-/-/-
B1T1	LW	-/-/-	-/-/-	-/-/-	-/-/-
B1T5	AMST/MBE	-/-/-	-/-/-	-/-/-	-/-/-
B1T6	AM 10K STER/O/O	-/-/-	-/-/-	-/-/-	-/-/-
B1T7	KARAOKE	-/-/-	-/-/-	-/-/-	-/-/-
B1T8	DSB	-/-/-	-/-/-	-/-/-	-/-/-
B1T9	AC-3	-/-/-	-/-/-	-/-/-	-/-/-
B1T10	BBS	-/-/-	-/-/-	-/-/-	-/-/-
B1T14	BBE	-/-/-	-/-/-	-/-/-	-/-/-

PIN NUMBERS

CON 202/203	ZAR-1	U	HR/HC	EZ	LH
ZAR-1	32/18	32/18	55/14	-	-
ZAR-2	32/9	32/14	55/9	-	-
ZAR-3	32/0	32/6	55/0	-	-
ZAR-4	32/0	32/6	55/0	-	-

ZAR-1/2	U	HR/HC	EZ	LH	B
ZAR-1	32/18	32/18	55/14	-	-
ZAR-2	32/9	32/14	55/9	-	-
ZAR-3	32/0	32/6	55/0	-	-
ZAR-4	32/0	32/6	55/0	-	-

ZAR-1/2/3/4	U	HR/HC	EZ	LH	B
R102, 103	U	HR/HC	EZ	LH	B
ZAR-1	JW	JW	JW	JW	JW
ZAR-2	JW	JW	JW	JW	JW
ZAR-3	JW	JW	JW	JW	JW
ZAR-4	JW	JW	JW	JW	JW

ZAR-1/2/3/4	U	HR/HC	EZ	LH	B
R405, 47	NONE	47	NONE	NONE	NONE
R121, 100	NONE	100	NONE	NONE	NONE
R221, 100	NONE	100	NONE	NONE	NONE
JM103, JW	JW	NONE	NONE	NONE	NONE

ZAR-1/2/3/4	U	HR/HC	EZ	LH	B
R134, R135	1K	1K	1K	1K	1K
ZAR-1/2	1K	1K	1K	1K	1K
ZAR-3/4	NONE	NONE	NONE	NONE	NONE
C190 (1000P)	U	HR/HC	EZ	LH	B

ZAR-1/2/3/4	U	HR/HC	EZ	LH	B
ZAR-1	U	HR/HC	EZ	LH	B
ZAR-2	U	HR/HC	EZ	LH	B
ZAR-3	U	HR/HC	EZ	LH	B
ZAR-4	U	HR/HC	EZ	LH	B

ZAR-1/2/3/4	U	HR/HC	EZ	LH	B
ZAR-1	JW	JW	JW	JW	JW
ZAR-2	JW	JW	JW	JW	JW
ZAR-3	JW	JW	JW	JW	JW
ZAR-4	JW	JW	JW	JW	JW

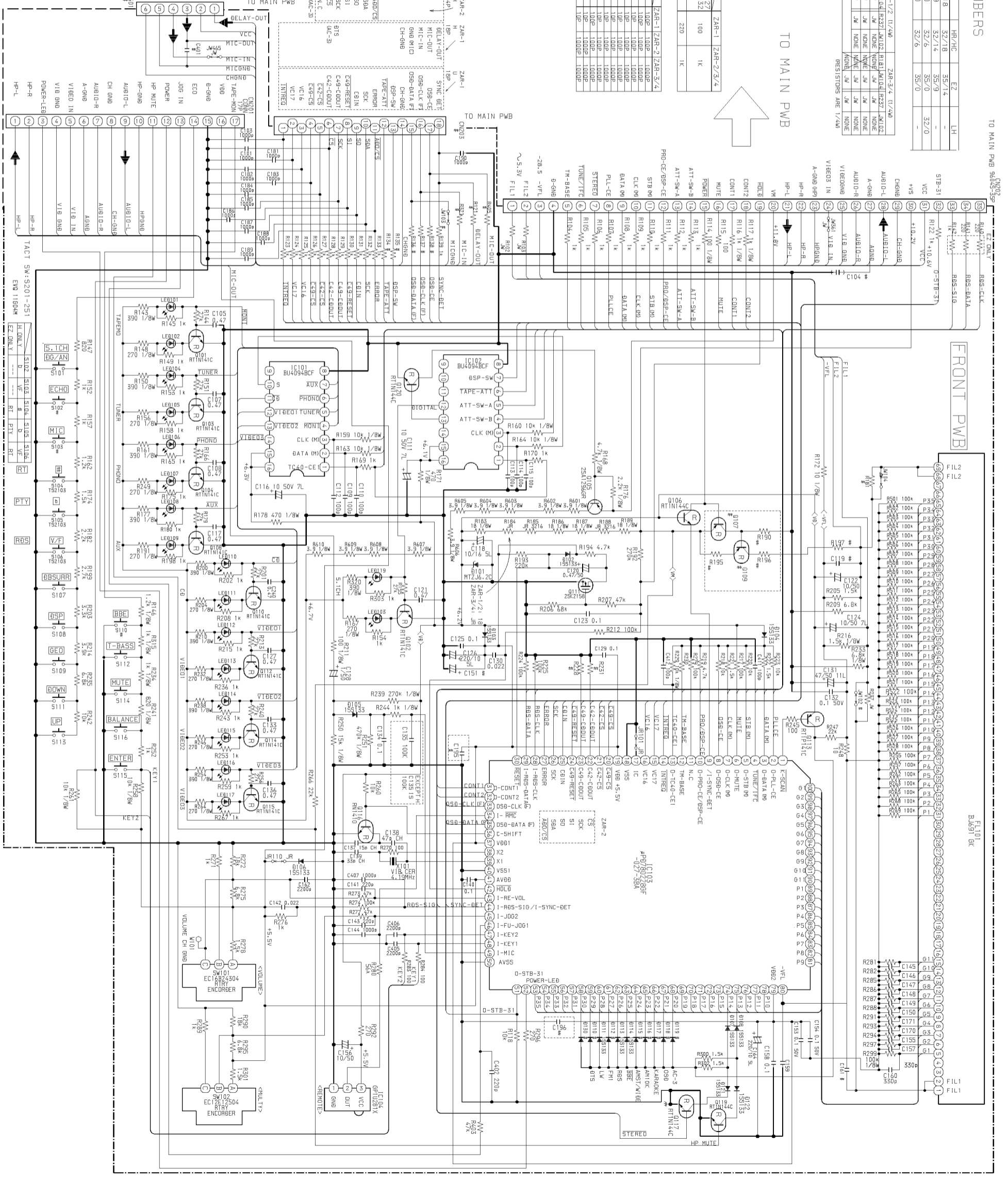

SCHEMATIC DIAGRAM - 3 (TUNER)

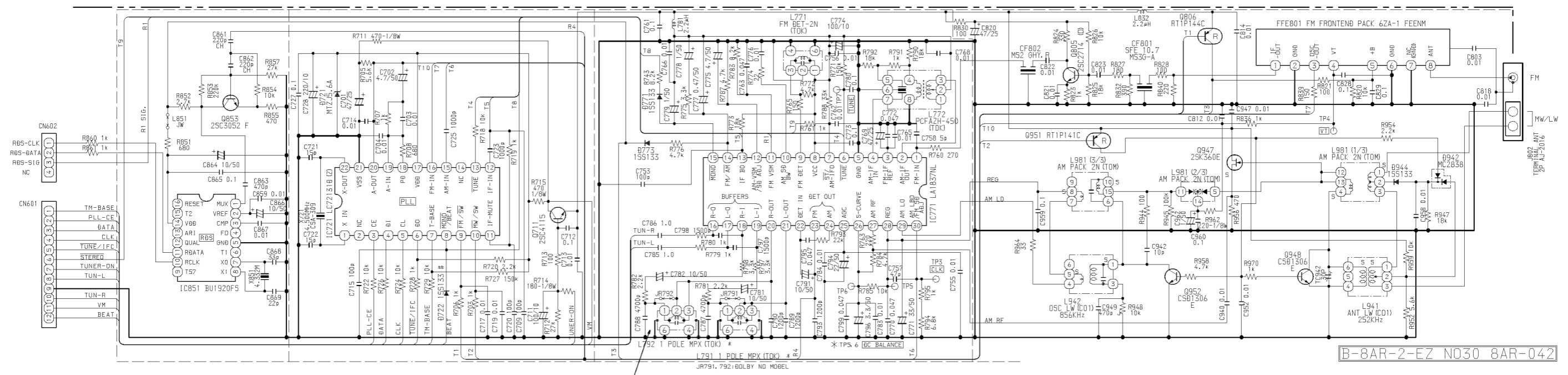

BOLBY MODEL USE L791 792 MPX
(1 POLE MPX (TOK))

B-8AR-2-EZ NO30 8AR-042

SCHEMATIC DIAGRAM - 4 (HP/VIDEO/GEQ)

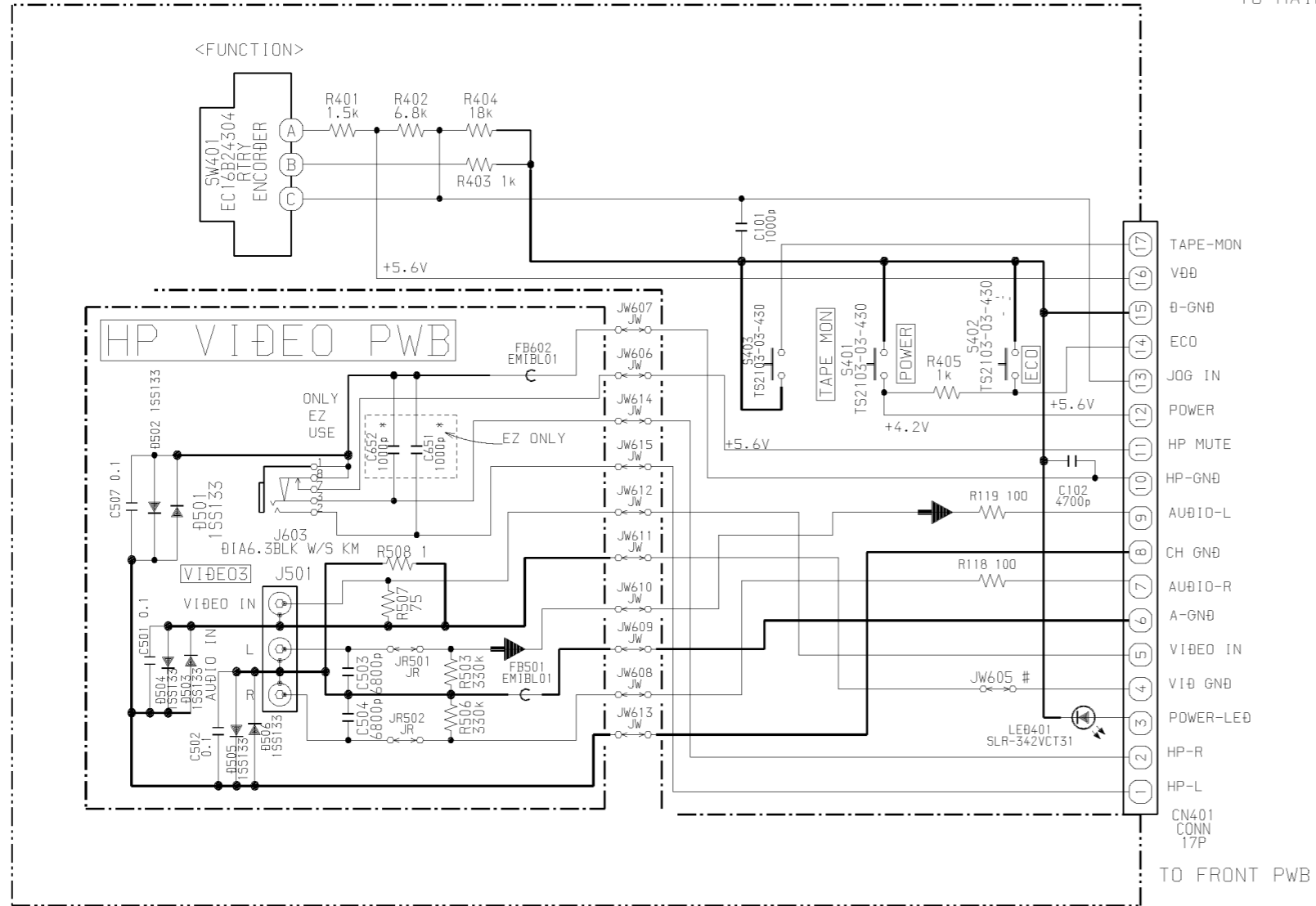

HP VIDEO PWB

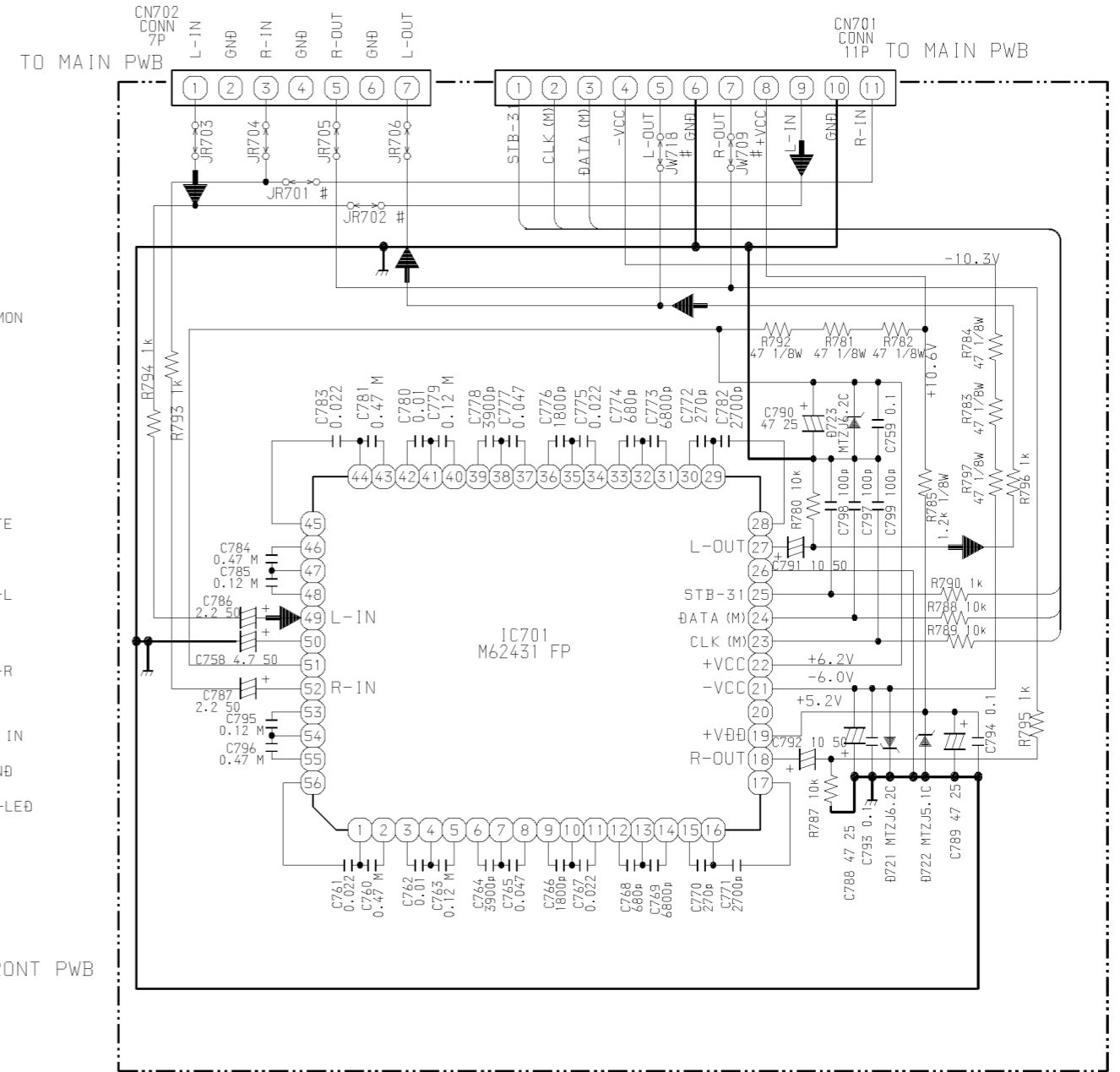

GEQ PWB

SCHEMATIC DIAGRAM - 5 (PROLOGIC)

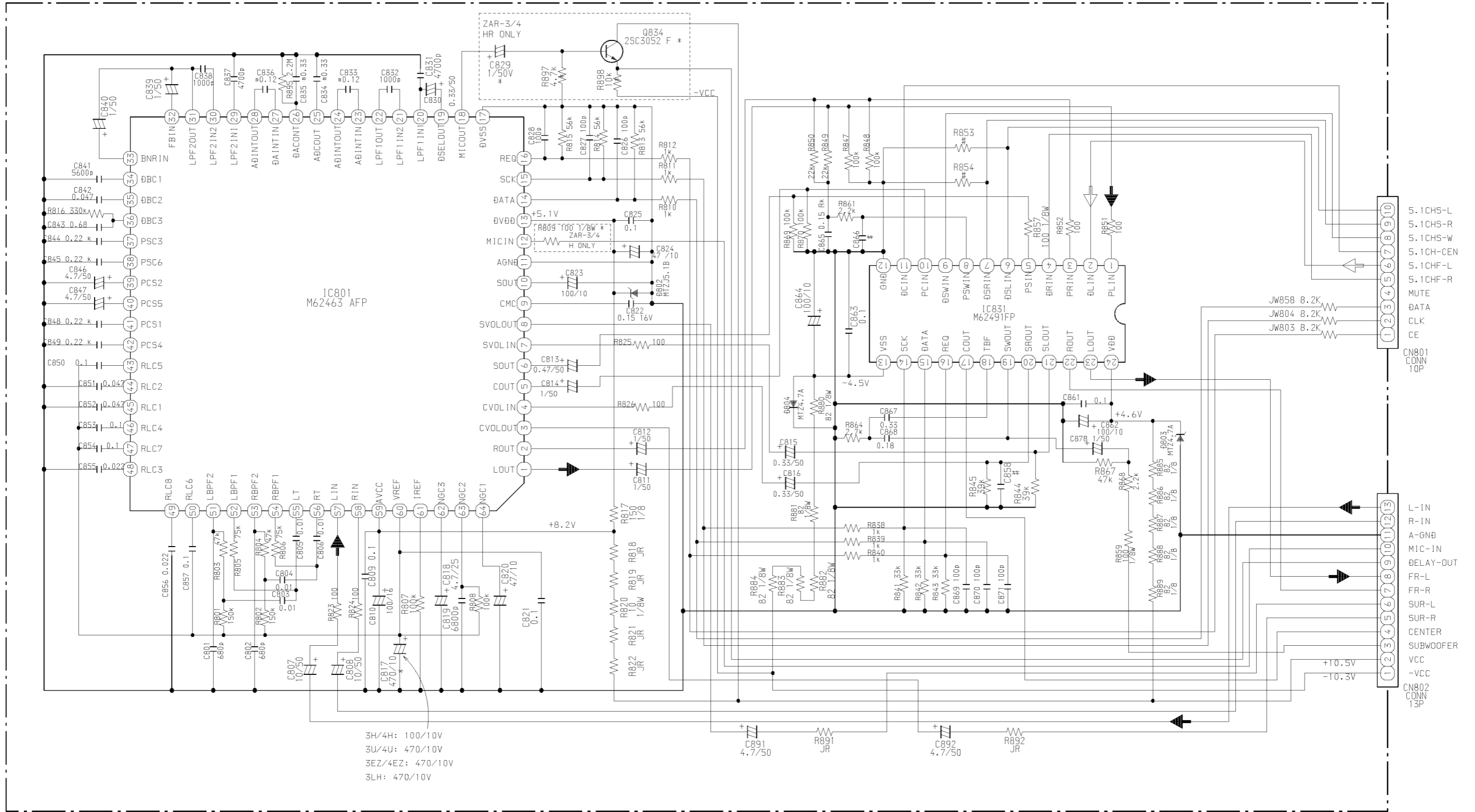

↙ : 5.1 CH AUDIO (FL)
 ↕ : AUX AUDIO (FL)

PRO LOGIC

SCHEMATIC DIAGRAM – 6 (PT)

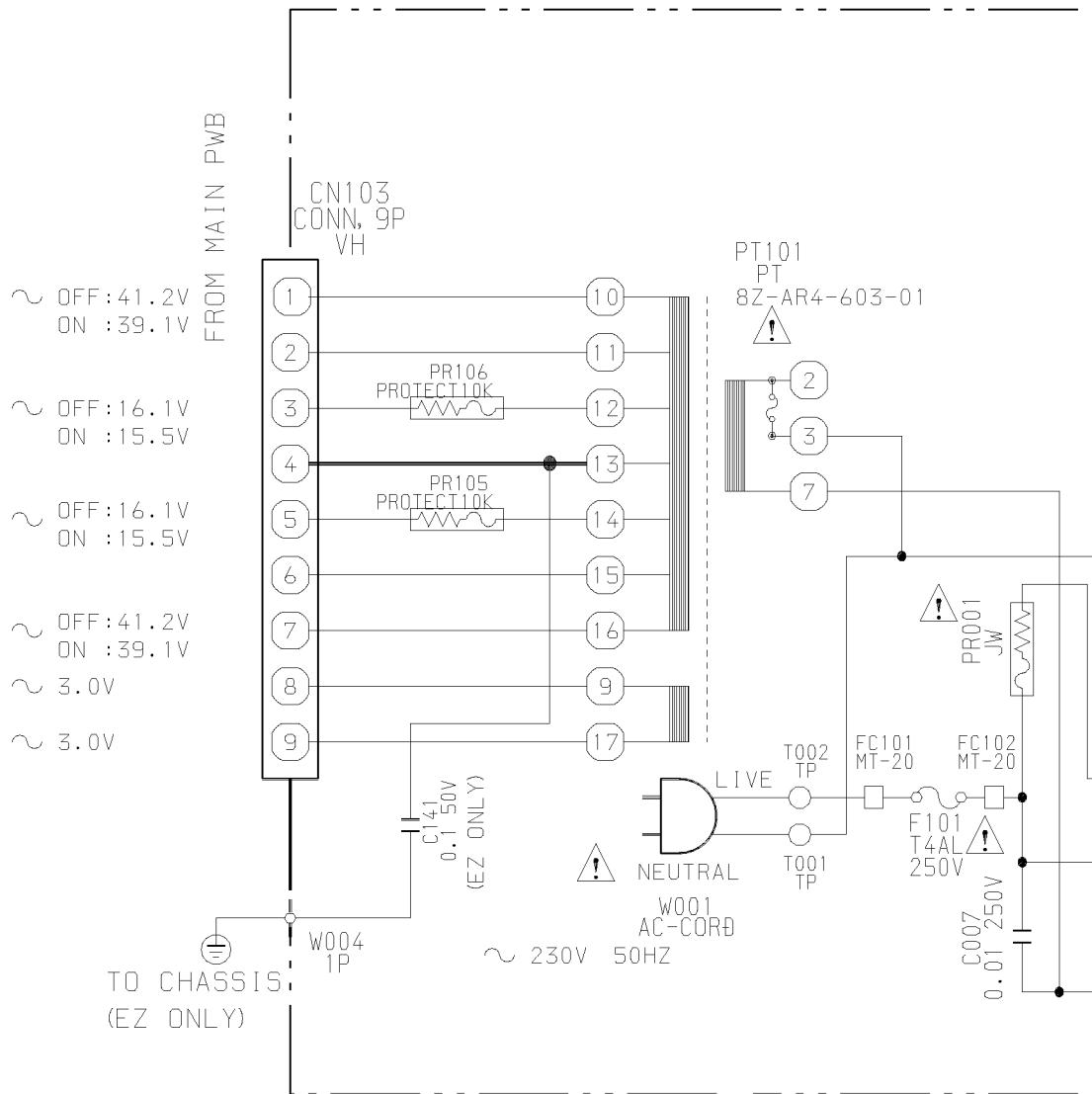

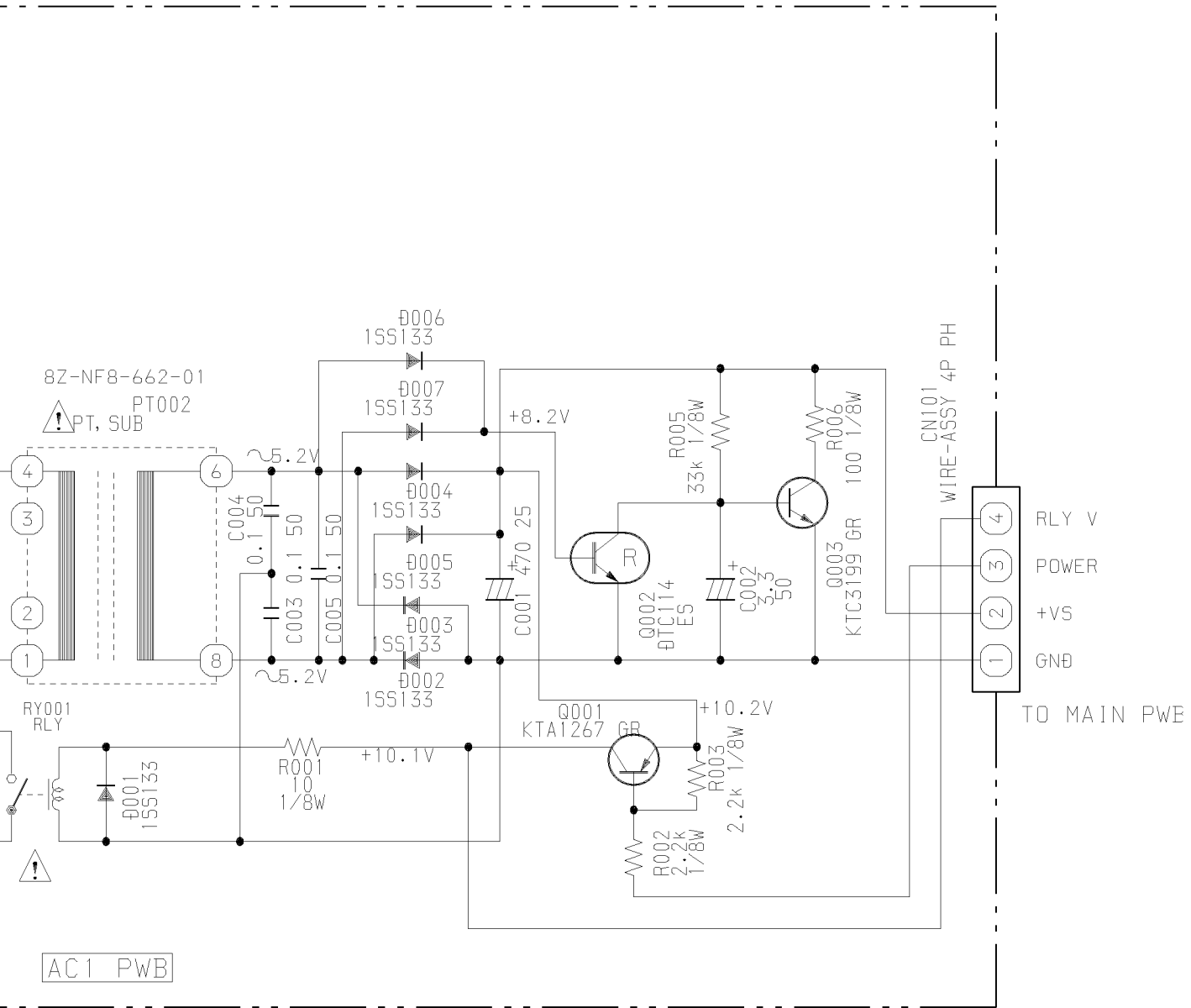

サービス技術ニュース	
番号	連絡内容
G- -	
G- -	
G- -	

アイワ株式会社
AIWA CO.,LTD.

931196

Tokyo Japan