

SERVICE MANUAL

CD CARRY COMPONENT SYSTEM

BASIC TAPE MECHANISM : TN-21ZSW-1694
BASIC CD MECHANISM : KSM-213CDM

This Service Manual is "Supplement" CA-DW535.

If requiring the other information, see Service Manual of the CA-DW535 U,LH,K
(S/M Code No. 09-995-402-1R1).

MECHANICAL PARTS LIST 1/1

DESCRIPTIONで判断できない物は "REFERENCE NAME LIST" を参照してください。
If can't understand for Description please kindly refer to "REFERENCE NAME LIST".

REF. NO	PART NO.	KANRI NO.	DESCRIPTION	REF. NO	PART NO.	KANRI NO.	DESCRIPTION
1	8Z-CT6-007-010		WINDOW, CASS L	30	8Z-CT6-029-010		WINDOW, CD
2	8Z-CT6-008-010		WINDOW, CASS R	31	8Z-CT6-204-010		BTN, CD BASE
3	8Z-CT6-005-010		BOX, CASS L	32	8Z-CT6-202-010		BTN, FUNC BASE
4	8Z-CT6-006-010		BOX, CASS R	33	8Z-CT6-203-010		BTN, GEQ BASE
5	8Z-CT6-003-010		BOX, CD	34	86-CD4-225-010		CHUCK(A)
6	8Z-CT6-001-010		CABI, FR	35	86-CT9-223-010		CUSH, FOOT
7	8Z-CT6-002-010		CABI, REAR	36	86-CT9-207-010		HLDR, ANT
8	8Z-CT6-004-010		CHAS, CD	37	86-CT9-205-110		HLDR, REC
9	8Z-CT6-026-010		HANDL, ARM	38	87-036-368-010		MAGNET
10	8Z-CT6-027-010		HANDL, GRIP	39	86-CT9-222-010		PLATE, MAGNET
11	8Z-CT6-021-010		LENS, LED	40	8Z-CT6-213-010		BASE, CHUCK
12	8Z-CT6-022-010		LENS, Q	41	86-CT9-220-110		OIL-DMPR, BRACKET
13	8Z-CT6-025-010		LID, BATT	42	86-CT9-219-110		OIL-DMPR, GEAR
14	8Z-CT6-010-010		PANEL, FR	43	86-CT9-212-010		SPR-C, BATT LINK
15	8Z-CT6-018-010		RING, Q	44	86-CT9-213-010		SPR-C, BATT(-)
16	8Z-CT6-012-010		RING, VOL	45	8Z-CT6-207-010		SPR-P, REC
17	8Z-CT6-009-010		WINDOW, DISP	46	86-CT9-210-010		SPR-T, CASS
18	8Z-CT6-030-010		BTN, BACK SKIP	47	86-CT9-211-010		SPR-T, CD
19	8Z-CT6-014-010		BTN, FUNC	48	87-A90-086-010		COVER, AC-SOCKET
20	8Z-CT6-031-010		BTN, FWD SKIP	49	88-CT6-633-010		ANT, ROD
21	8Z-CT6-016-010		BTN, GEQ<U, K>	△ 50	87-A60-178-010		JACK, AC E W/SW<LH, K>
21	8Z-CT6-040-010		BTN, GEQ LH<LH>	△ 50	87-A60-177-010		JACK, AC U W/SW<U>
22	8Z-CT6-015-010		BTN, PLAY	△ 51	88-CT6-631-010		POWER TRANS, EI-57/25<LH>
23	8Z-CT6-017-010		BTN, Q	△ 51	88-CT6-630-010		PT, EZ/K<K>
24	8Z-CT6-028-010		BTN, STOP	△ 51	88-CT6-602-010		PT, U<U>
25	8Z-CT6-011-010		BTN, VOL	52	8Z-CT6-201-010		HLDR, LCD
26	8Z-CT6-023-010		KEY, CASS A	53	8Z-CT6-205-010		HLDR, LED FUNC
27	8Z-CT6-024-010		KEY, CASS B	54	8Z-CT6-206-010		HLDR, LED Q
28	8Z-CT6-019-010		KNOB, RTRY MIC	55	8Z-CT6-208-010		HLDR, KEY
29	86-CT9-026-010		PLATE, AC	56	87-036-389-010		SW, PUSH LOCK
				△ 57	87-A91-302-010		SW, AC SL 2 2 2 SDKGA40100<LH>
				A	81-CD5-204-010		SCREW CD

SPEAKER PARTS LIST

DESCRIPTIONで判断できない物は "REFERENCE NAME LIST" を参照してください。
If can't understand for Description please kindly refer to "REFERENCE NAME LIST".

REF. NO	PART NO.	KANRI NO.	DESCRIPTION
1	86-CT9-040-010		BADGE, AIWA -
2	8Z-CT6-101-010		CABI, SPKR FR
3	8Z-CT6-103-010		CABI, SPKR REAR L
4	8Z-CT6-102-010		CABI, SPKR REAR R
5	87-CT7-154-010		CAP, SPKR
6	8Z-CT6-044-010		GRILLE, SPKR
7	88-CT6-045-010		HLDR, CORD
8	88-CT6-628-010		PIEZO TWEETWR 27MM
9	88-CT6-627-010		SPEAKER, 5'40HM 5W
A	87-651-100-410		VT1+3-16

MECHANICAL EXPLODED VIEW 1/1

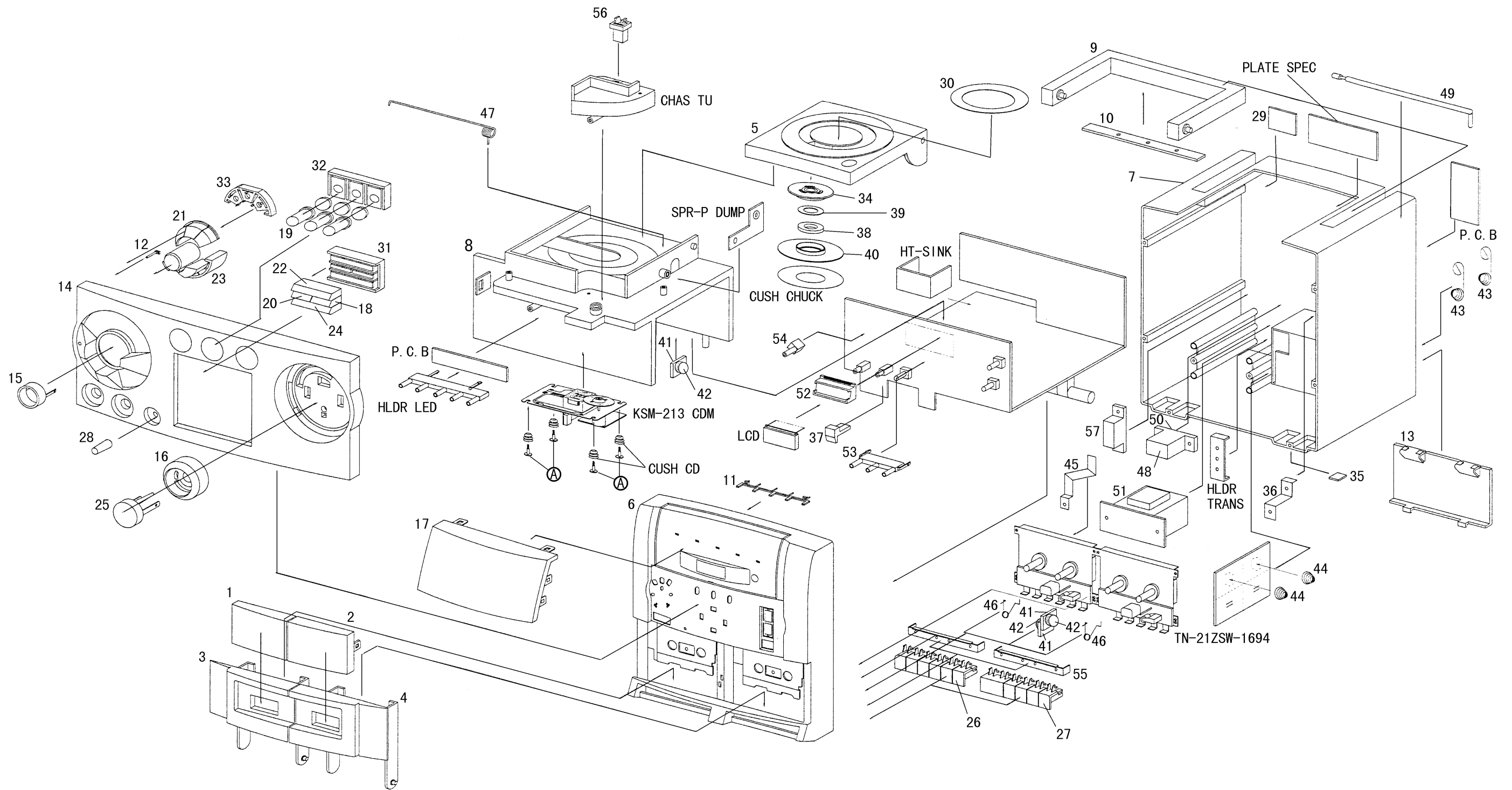

サービス技術ニュース	
番号	連絡内容
G- -	
G- -	
G- -	

アイワ株式会社 〒110-8710 東京都台東区池之端1-2-11 ☎03(3827)3111 (代表)
AIWA CO.,LTD. 2-11, IKENOHATA 1-CHOME, TAITO-KU, TOKYO 110, JAPAN TEL:03 (3827) 3111