



Philips Domestic Appliances and Personal Care

Service Manual

PRODUCT INFORMATION

- Product meets the requirements regarding interference suppression on radio and television.
- After the product has been repaired, it should function properly and has to meet the safety requirements as laid down officially established at this moment.

TECHNICAL INFORMATION

- Power consumption : 300 W
- Voltage and frequency : 230 V / 50 - 60 Hz
- Cord length : 130 cm
- Speed unloaded : 18.000 rpm
- Volume beaker : 500 ml
- Volume chopper container : 250 ml
- Weight in F-box : 1.8 kg
- Dimensions F-box : 310 x 150 x 244 mm

DISASSEMBLY AND RE-ASSEMBLY ADVISE

- No specific issues.

REPAIR INSTRUCTION

- No specific issues.

OPTIONAL (accessories)

- No specific issues.

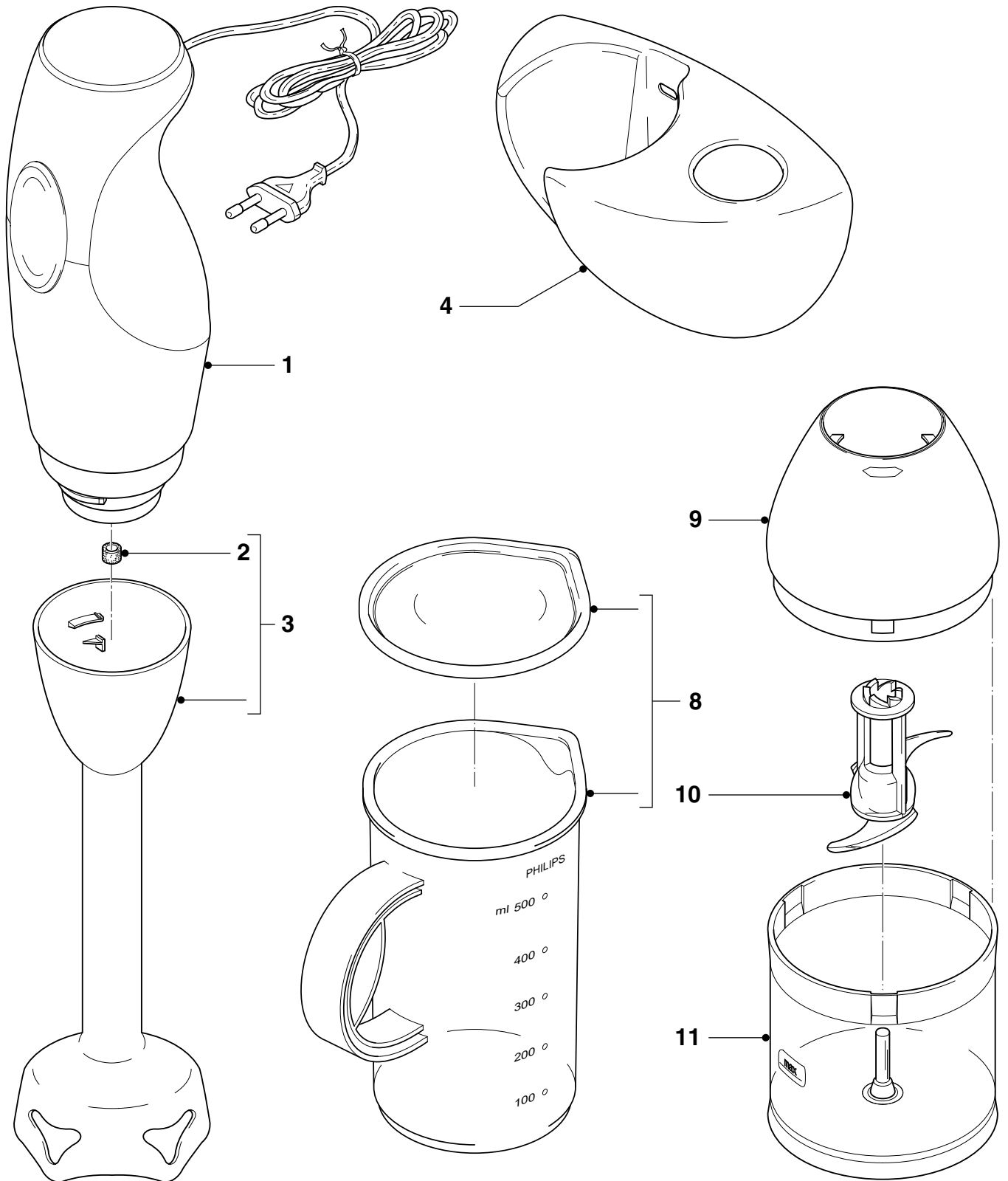

Pos	Service code	Description
1	9965 000 17067	power unit 1 speed
2	9965 000 01713	rubber ring
3	9965 000 17068	metal bar
4	9965 000 17069	wall holder

Pos	Service code	Description
8	9965 000 17070	beaker (0,5 L) and lid
9	9965 000 17071	chopper gear box
10	9965 000 17072	chopping knife
11	9965 000 17073	chopping bowl